

SK8680

POSITRONIC INDUSTRIES BELIEVES THE DATA ON THIS DRAWING TO BE RELIABLE. SINCE THE TECHNICAL INFORMATION IS GIVEN FREE OF CHARGE, THE USER EMPLOYS SUCH INFORMATION AT HIS OWN DISCRETION AND RISK. POSITRONIC INDUSTRIES ASSUMES NO RESPONSIBILITY FOR RESULTS OBTAINED OR DAMAGES INCURRED FROM USE OF SUCH INFORMATION IN WHOLE OR IN PART.

DATE	REV	REVISION RECORD	APP	DR	CK
6-26-07	NC	ECO 28090		YK	

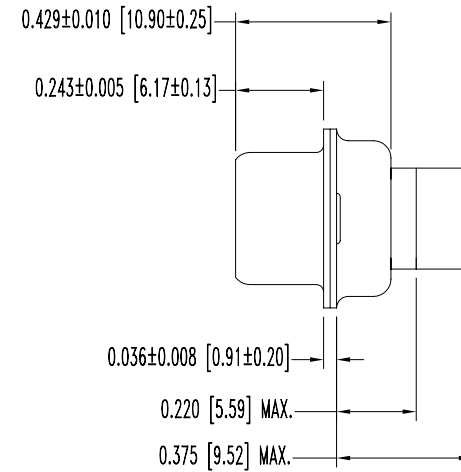
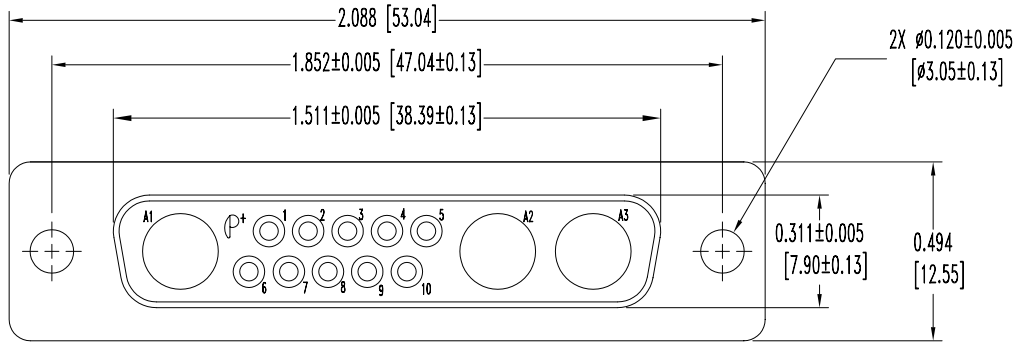

NOTES:

- MATERIALS AND FINISHES:  
INSULATOR: GLASS FILLED POLYESTER PER MIL-M-24519, UL 94V-0, BLUE COLOR.  
SHELLS: STEEL, CADMIUM PLATE WITH CHROMATE SEAL.
- ELECTRICAL CHARACTERISTICS:  
INSULATION RESISTANCE: 5 G OHMS.  
WORKING VOLTAGE: 300 V r.m.s.
- TEMPERATURE RANGE: -55°C TO +125°C.
- DIMENSIONS ARE IN INCHES [MILLIMETERS].

		<b>POSITRONIC INDUSTRIES INC.</b> www.connectpositronic.com		FSCM 28198
		CBC SERIES		SCALE: N.T.S. DRAWN BY: YK APPROVED BY:
DECIMAL TOL. ± 0.015 [0.38]		TITLE: CBC13W3F0000C		
ANGULAR TOL. ± 5°		DATE: 6-26-07	DRAWING NUMBER: SK8680	REV.: NC