

SK4341

POSITRONIC INDUSTRIES BELIEVES THE DATA ON THIS DRAWING TO BE RELIABLE. SINCE THE TECHNICAL INFORMATION IS GIVEN FREE OF CHARGE, THE USER EMPLOYS SUCH INFORMATION AT HIS OWN DISCRETION AND RISK. POSITRONIC INDUSTRIES ASSUMES NO RESPONSIBILITY FOR RESULTS OBTAINED OR DAMAGES INCURRED FROM USE OF SUCH INFORMATION IN WHOLE OR IN PART.

DATE	REV	REVISION RECORD	APP	DR	CK
5-28-02	NC	ECO 19505		YK	

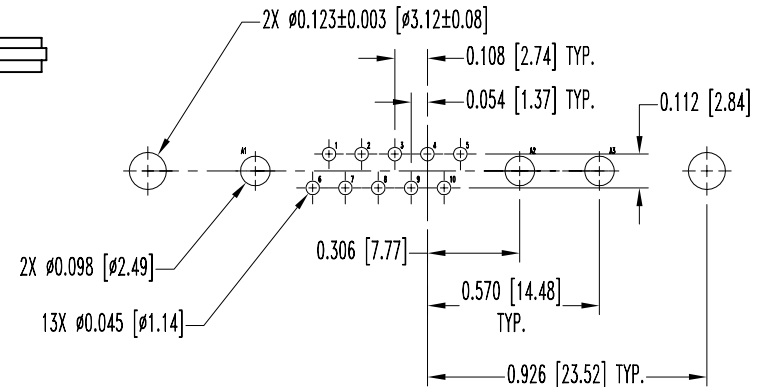
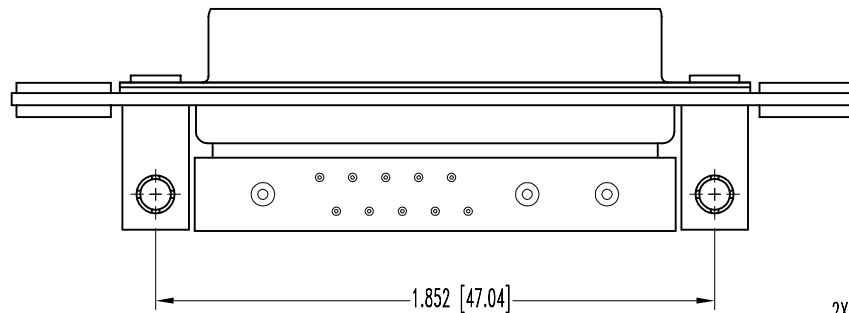
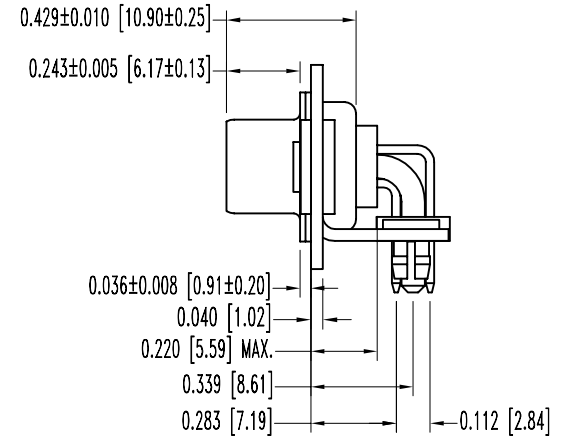
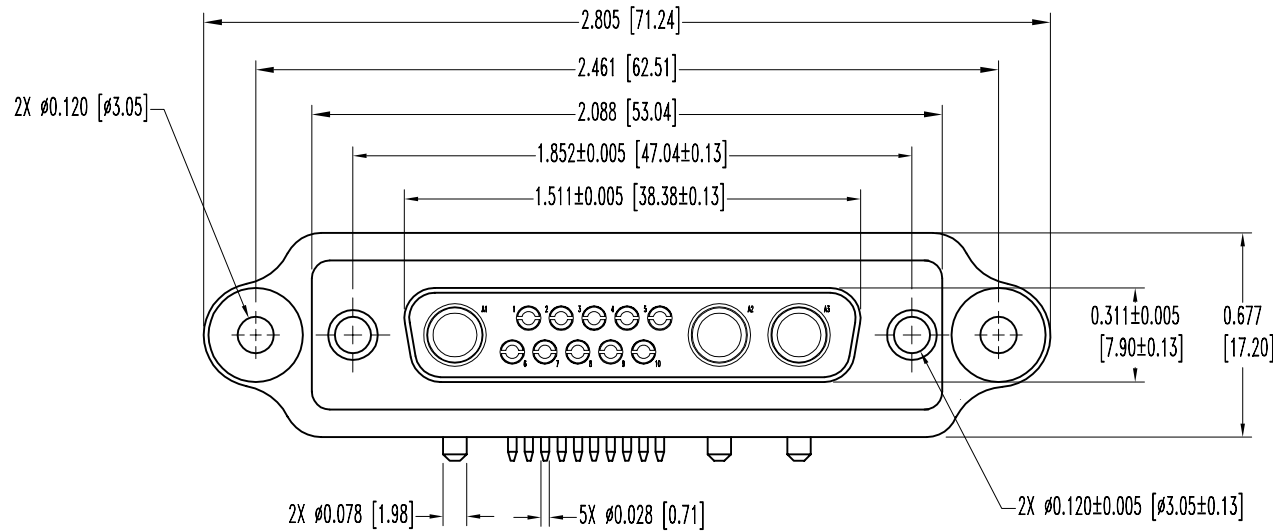

NOTES:

1. MATERIALS AND FINISHES:

- INSULATOR: GLASS FILLED POLYESTER PER MIL-M-24519 UL 94V-0, BLUE COLOR.
- SIGNAL CONTACTS: PRECISION MACHINED HIGH TENSILE PHOSPHOR BRONZE, GOLD FLASH OVER NICKEL PLATE.
- POWER CONTACTS-HIGH CONDUCTIVITY COPPER ALLOY, GOLD FLASH OVER NICKEL PLATE.
- SHELLS: STEEL, ZINC PLATE WITH DICHROMATE SEAL.
- BRACKETS: BRASS, ZINC PLATE WITH DICHROMATE SEAL.
- MOUNTING PLATE: ALUMINUM, YELLOW ANODIZED.

2. ELECTRICAL CHARACTERISTICS:

- SIGNAL CONTACT CURRENT RATING: 7.5 AMPERES NOMINAL.
- POWER CONTACT CURRENT RATING: 15 AMPERES NOMINAL.
- INITIAL CONTACT RESISTANCE: 0.008 OHMS MAXIMUM.
- INSULATOR RESISTANCE: 5 G OHMS.
- WORKING VOLTAGE: 300 V r.m.s.

4. TEMPERATURE RANGE: -55°C TO +125°C.

5. DIMENSIONS ARE IN INCHES [MILLIMETERS].

		POSITRONIC INDUSTRIES INC. www.connectpositronic.com	
 DECIMAL TOL. ± 0.015 [0.38]	CBD SERIES	SCALE	DRAWN BY Y. KELLEYBREW
		N.T.S.	APPROVED BY
WF # 4565	TITLE CBD13W3F55R6N00-759.1		
 ANGULAR TOL. ± 5°	DATE 5-28-02	DRAWING NUMBER SK4341	REV. NC