

SK11921

THIS DRAWING CONTAINS INFORMATION PROPRIETARY TO POSITRONIC AND ITS SUBSIDIARIES. POSITRONIC BELIEVES THE DATA ON THIS DRAWING TO BE RELIABLE. SINCE THE TECHNICAL INFORMATION IS GIVEN FREE OF CHARGE, THE USER EMPLOYS SUCH INFORMATION AT HIS OWN DISCRETION AND RISK. POSITRONIC ASSUMES NO RESPONSIBILITY FOR RESULTS OBTAINED OR DAMAGES INCURRED FROM USE OF SUCH INFORMATION IN WHOLE OR IN PART.

DATE	REV	REVISION RECORD	APP	DR	CK
11-10	NC	ECO 33281	COLE	BS	COLE

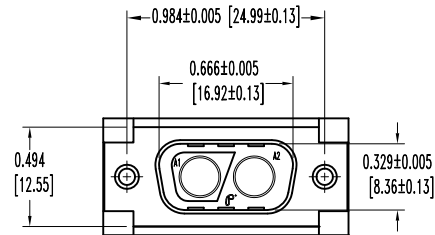
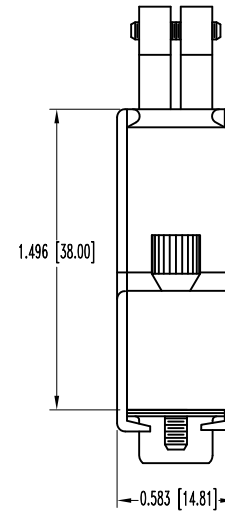
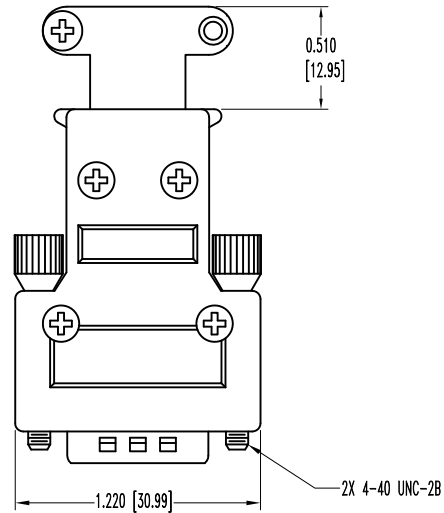

NOTES:

1. MATERIALS AND FINISHES:  
 INSULATOR: GLASS FILLED POLYESTER PER ASTM-D5927, UL 94V-0, COLOR: BLUE.  
 SHELLS: DIMPLED STEEL WITH TIN PLATE.  
 HOOD AND CABLE CLAMPS: DIE CAST ZINC.  
 JACKSCREWS: STEEL WITH NICKEL PLATE.  
 SCREWS: STEEL WITH NICKEL PLATE.
2. DETAILED PRODUCT, MECHANICAL, AND ELECTRICAL INFORMATION IS AVAILABLE IN THE LATEST STANDARD DENSITY COMBO-D PRODUCT PUBLICATION. VISIT [CONNECTPOSITRONIC.COM/PRODUCTS/1/STANDARDENSITYCOMBO-D](http://CONNECTPOSITRONIC.COM/PRODUCTS/1/STANDARDENSITYCOMBO-D) OR [CONNECTPOSITRONIC.COM](http://CONNECTPOSITRONIC.COM).
3. CONNECTORS ARE ROHS COMPLIANT PER ROHS DIRECTIVE 2002/95/EC OF 27 JAN 2003.
4. DIMENSIONS ARE IN INCHES [MILLIMETERS].

	<b>POSITRONIC INDUSTRIES INC.</b> <a href="http://www.connectpositronic.com">www.connectpositronic.com</a>		FSCM 28198
		SCALE <b>N.T.S.</b>	DRAWN BY <b>B SHELLEDY</b>
DECIMAL TOL <b>± 0.015 [0.38]</b>	TITLE <b>CBD2WK2MOOGEZ/AA</b>	APPROVED BY <b>COLE</b>	
ANGULAR TOL <b>± 5°</b>	DATE <b>11-10-10</b>	DRAWING NUMBER <b>SK11921</b>	REV. <b>NC</b>