

SK8567

POSITRONIC INDUSTRIES BELIEVES THE DATA ON THIS DRAWING TO BE RELIABLE. SINCE THE TECHNICAL INFORMATION IS GIVEN FREE OF CHARGE, THE USER EMPLOYS SUCH INFORMATION AT HIS OWN DISCRETION AND RISK. POSITRONIC INDUSTRIES ASSUMES NO RESPONSIBILITY FOR RESULTS OBTAINED OR DAMAGES INCURRED FROM USE OF SUCH INFORMATION IN WHOLE OR IN PART.

DATE	REV	REVISION RECORD	APP	DR	CK
5-15-07	NC	ECO 27908		YK	

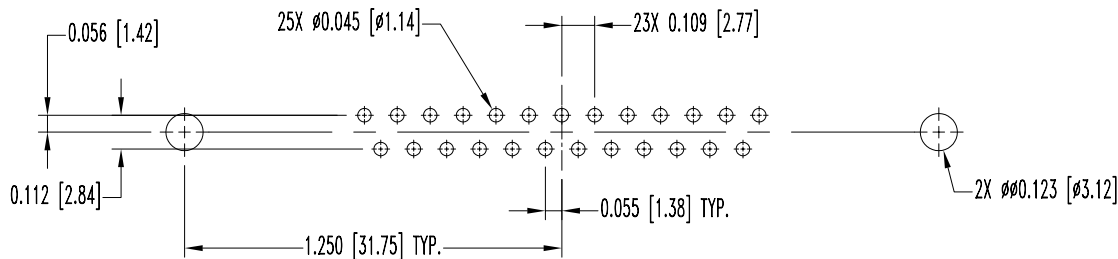
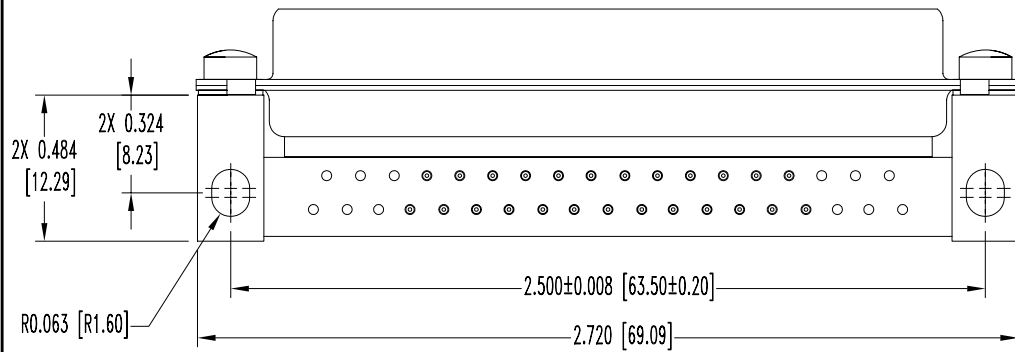
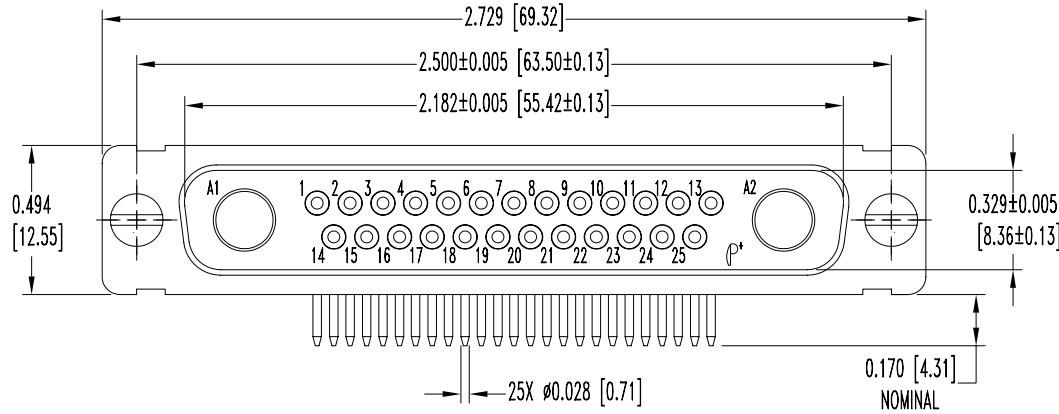

CONTACT HOLE PATTERN

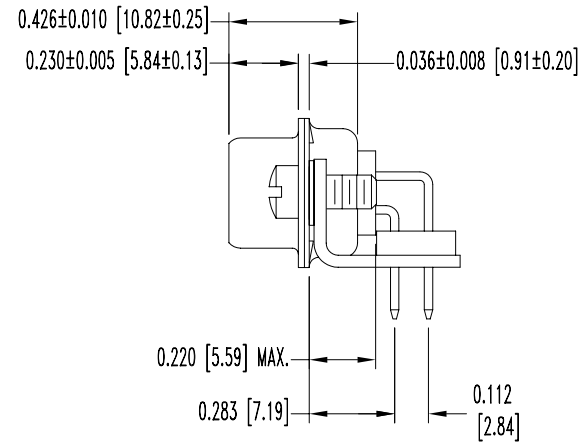

NOTES:

- MATERIALS AND FINISHES:
 INSULATOR: GLASS FILLED POLYESTER PER MIL-M-24519 UL 94V-0, BLUE COLOR.
 CONTACTS: PRECISION MACHINED BRASS ALLOY, WITH GOLD FLASH OVER FINISH.
 SHELLS: STAINLESS STEEL, PASSIVATED.
 MOUNTING BRACKETS: BRASS, ZINC PLATE WITH CHROMATE SEAL.
 ALIGNMENT BAR: NYLON, COLOR BLACK.
 SCREWS: STEEL, ZINC PLATE WITH CHROMATE SEAL.
 WASHERS: STAINLESS STEEL, PASSIVATED.
- ELECTRICAL CHARACTERISTICS:
 CONTACT CURRENT RATING: 7.5 AMPERES NOMINAL.
 INITIAL CONTACT RESISTANCE: SIGNAL: 0.008 OHMS MAXIMUM.
 INSULATOR RESISTANCE: 5 G OHMS.
 WORKING VOLTAGE: 300 V r.m.s.
- TEMPERATURE RANGE: -55°C TO +125°C,
- DIMENSIONS ARE IN INCHES [MILLIMETERS].

 POSITRONIC INDUSTRIES INC. www.connectpositronic.com		FSCM 28198	
DECIMAL TOL. ± 0.015 [0.38]	CBM SERIES	SCALE N.T.S.	DRAWN BY YK
ANGULAR TOL. ± 5°	DATE 5-15-07	DRAWING NUMBER SK8567	REV. NC
TITLE CBM27W2M5B300S			
APPROVED BY			