

THIS DRAWING CONTAINS INFORMATION PROPRIETARY TO POSITRONIC AND ITS SUBSIDIARIES. POSITRONIC BELIEVES THE DATA ON THIS DRAWING TO BE RELIABLE. SINCE THE TECHNICAL INFORMATION IS GIVEN FREE OF CHARGE, THE USER EMPLOYS SUCH INFORMATION AT HIS OWN DISCRETION AND RISK. POSITRONIC ASSUMES NO RESPONSIBILITY FOR RESULTS OBTAINED OR DAMAGES INCURRED FROM USE OF SUCH INFORMATION IN WHOLE OR IN PART.

DATE	REV	REVISION RECORD	APP	DR	CK
8-04-09	NC	ECO 31055	RCW	BS	TK

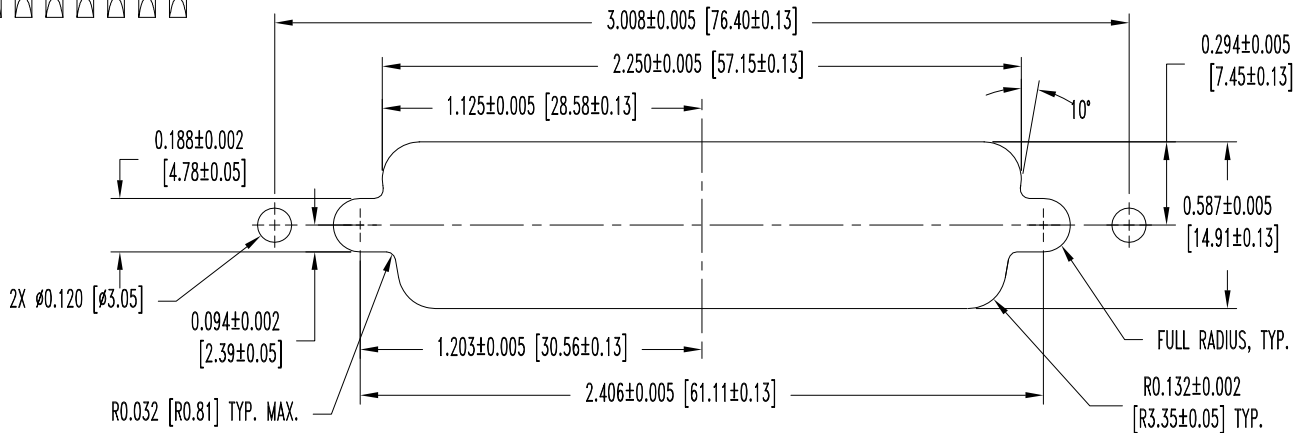
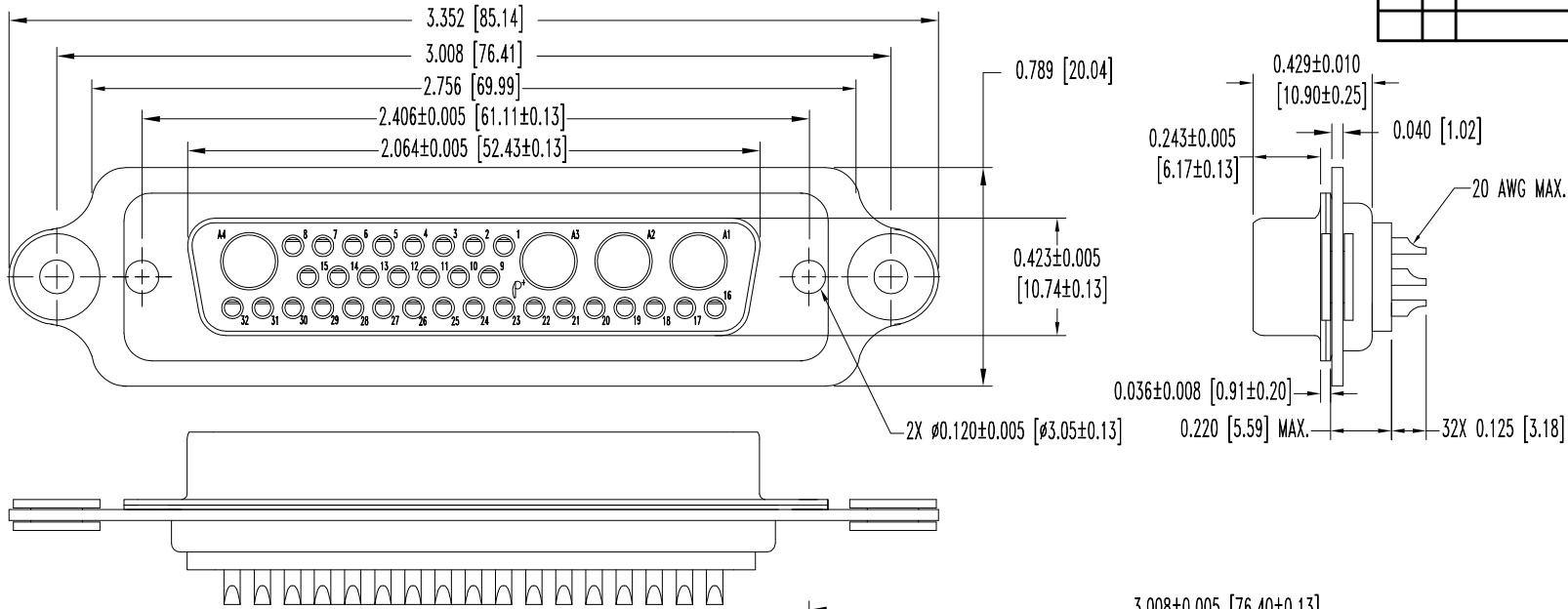

NOTES:

- MATERIALS AND FINISHES:  
 INSULATOR: GLASS FILLED POLYESTER PER MIL-M-24519 UL 94V-0, BLUE COLOR.  
 CONTACTS: PRECISION MACHINED COPPER ALLOY, 0.000050 INCH [1.27μ] GOLD OVER NICKEL PLATE.  
 MOUNTING PLATE: ALUMINUM, YELLOW ANODIZED.  
 SHELLS: STEEL WITH TIN PLATE.
- ELECTRICAL CHARACTERISTICS:  
 SIGNAL CONTACTS:  
 CONTACT CURRENT RATING: 7.5 AMPERES NOMINAL.  
 INITIAL CONTACT RESISTANCE: 0.008 OHMS MAXIMUM.  
 PROOF VOLTAGE: 1000 V r.m.s.  
 INSULATOR RESISTANCE: 5 G OHMS.  
 WORKING VOLTAGE: 300 V r.m.s.  
 TEMPERATURE RANGE: -55°C TO +125°C.
- THIS MOS ALLOWS FOR CONNECTOR TO INCLUDE BLIND MATE MOUNTING PLATE.
- DIMENSIONS ARE IN INCHES [MILLIMETERS].

PANEL CUT-OUT

 <b>POSITRONIC INDUSTRIES INC.</b> www.connectpositronic.com		FSCM 28198	
DECIMAL TOL. $\pm 0.015$ [0.38]		SCALE N.T.S.	DRAWN BY B SHELEDDY
TITLE CBM36W4S2000X-759.1		APPROVED BY R WILLIAMS	
ANGULAR TOL. $\pm 5^\circ$		DATE 8-04-09	DRAWING NUMBER SK10752
			REV. NC