

SK5807

POSITRONIC INDUSTRIES BELIEVES THE DATA ON THIS DRAWING TO BE RELIABLE. SINCE THE TECHNICAL INFORMATION IS GIVEN FREE OF CHARGE, THE USER EMPLOYS SUCH INFORMATION AT HIS OWN DISCRETION AND RISK. POSITRONIC INDUSTRIES ASSUMES NO RESPONSIBILITY FOR RESULTS OBTAINED OR DAMAGES INCURRED FROM USE OF SUCH INFORMATION IN WHOLE OR IN PART.

DATE	REV	REVISION RECORD	APP	DR	CK
11-5-04	NC	ECO 23238		ME	

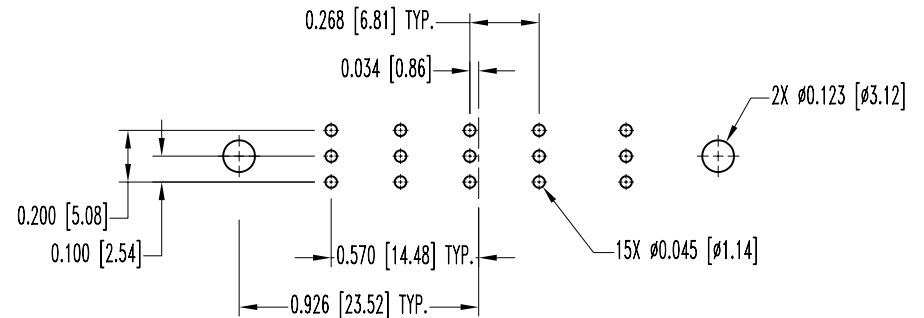
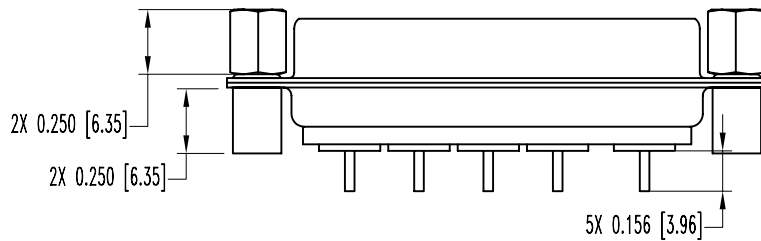
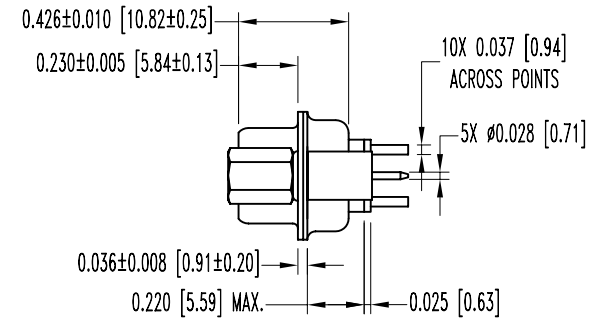
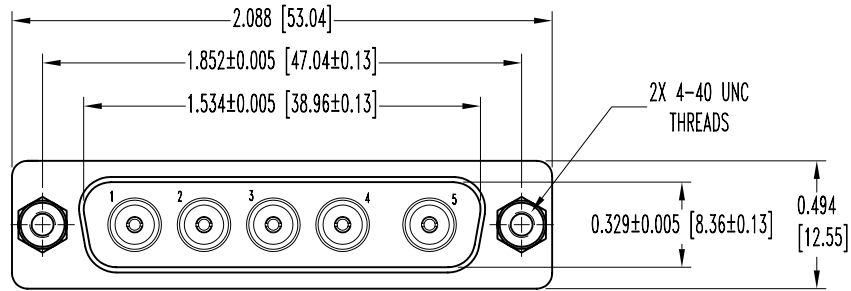

CONTACT HOLE PATTERN

NOTES:

- MATERIALS AND FINISHES:
 - INSULATOR: GLASS-FILLED POLYESTER PER MIL-M-24519, UL 94V-0, BLUE COLOR.
 - SHELLS: STEEL, ZINC PLATED WITH DICHROMATE SEAL.
 - CONTACTS: COPPER ALLOY WITH PTFE TEFLON INSULATOR.
 - SIGNAL CONTACT PLATING: 0.000030 [0.75µ] GOLD OVER NICKEL.
 - CONTACT BODY PLATING: GOLD FLASH OVER NICKEL.
 - SPACERS: STEEL, ZINC PLATE WITH DICHROMATE SEAL.
 - JACKSCREWS: BRASS, ZINC PLATE WITH DICHROMATE SEAL.
- ELECTRICAL CHARACTERISTICS:
 - INITIAL CONTACT RESISTANCE: 0.008 OHMS, MAXIMUM.
 - NOMINAL IMPEDANCE: 50 OHMS.
 - INSERTION LOSS: -0.46 dB AT 1 GHz
 - 1.5 dB AT 2 GHz
 - VSWR: 1.15 AVERAGE AT 1 GHz
 - 1.56 AVERAGE AT 2 GHz
 - PROOF VOLTAGE: 1,000 V r.m.s.
 - INSULATOR RESISTANCE: 5 G OHMS.
 - WORKING VOLTAGE: 300 V r.m.s.
- WORKING TEMPERATURE: -55° TO +125°C.
- DIMENSIONS ARE IN INCHES [MILLIMETERS].

 POSITRONIC INDUSTRIES INC. www.connectpositronic.com		SCALE		DRAWN BY	
DECIMAL TOL. ± 0.015 [0.38]		CBM SERIES		N.T.S.	
TITLE CBM5W5M65S0T0		DATE 11-5-04		DRAWING NUMBER SK5807	
ANGULAR TOL. ± 5°		REV. NC		APPROVED BY M. ENEA	