

SK5201

POSITRONIC INDUSTRIES BELIEVES THE DATA ON THIS DRAWING TO BE RELIABLE. SINCE THE TECHNICAL INFORMATION IS GIVEN FREE OF CHARGE, THE USER EMPLOYS SUCH INFORMATION AT HIS OWN DISCRETION AND RISK. POSITRONIC INDUSTRIES ASSUMES NO RESPONSIBILITY FOR RESULTS OBTAINED OR DAMAGES INCURRED FROM USE OF SUCH INFORMATION IN WHOLE OR IN PART.

DATE	REV	REVISION RECORD	APP	DR	CK
11-11-03	NC	ECO 21682	RCW	YK	COLE
12-28-06	A	ECO 27242		YK	

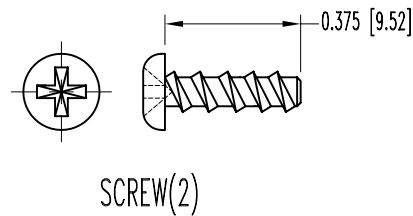
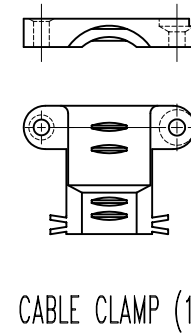
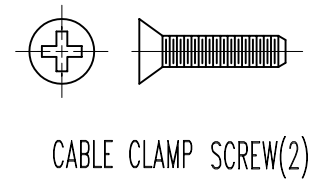
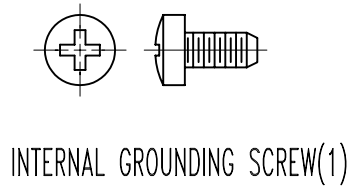
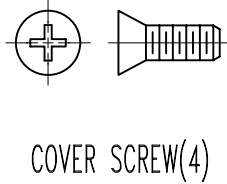
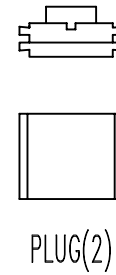
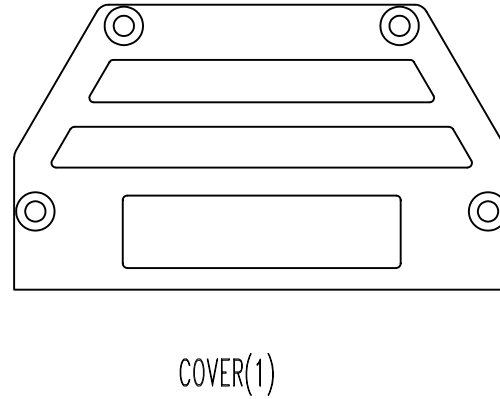
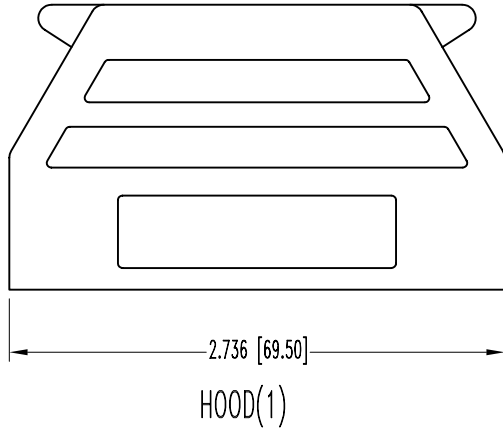

- NOTES:
- HOOD CONSISTS OF: (1) HOOD, (1) COVER, (2) PLUGS, (4) COVER SCREWS, (1) INTERNAL SCREW, (2) SHOULDER SCREWS, 1 SET CABLE CLAMPS AND (2) CABLE CLAMP SCREWS.
 - ALL DIMENSIONS ARE SHOWN FOR REFERENCE ONLY.
 -
 - DIMENSIONS ARE IN INCHES[MILLIMETERS].

		POSITRONIC INDUSTRIES INC. www.connectpositronic.com	
	D SERIES	SCALE N.T.S.	DRAWN BY Y.KELLEYBREW
± 0.005 [0.38]	TITLE D37000G00		
APPROVED BY RCW	DATE 11-11-03	DRAWING NUMBER SK5201	REV. A
ANGULAR TOL. ± 5°			