

SK10698

THIS DRAWING CONTAINS INFORMATION PROPRIETARY TO POSITRONIC IND. INC. ANY REPRODUCTION, DISCLOSURE OR USE OF THIS DRAWING IS EXPRESSLY PROHIBITED, EXCEPT AS POSITRONIC IND. INC. MAY OTHERWISE AGREE IN WRITING.

DATE	REV	REVISION RECORD	APP	DR	CK
5-07-09	NC	ECO 31038	RCW	BS	COLE

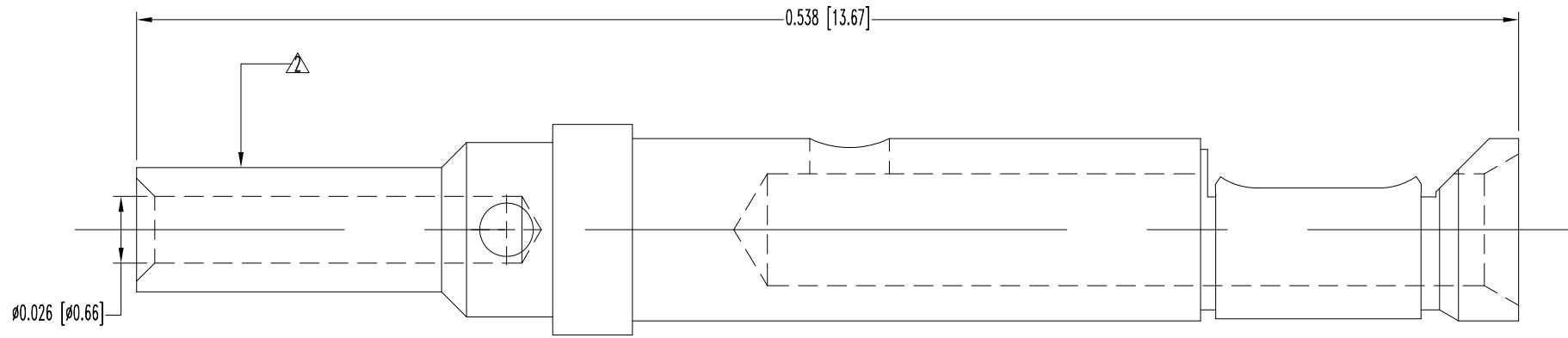

NOTES:

- MATERIALS:
 CONTACT: ALUMEL
 SPRING CLIP: BERYLLIUM COPPER, GOLD FLASH OVER NICKEL PLATE.
 CONTACT PERMANENTLY MARKED WITH GREEN ID BAND.
- DIMENSIONS ARE IN INCHES [MILLIMETERS].

	POSITRONIC INDUSTRIES INC. SPRINGFIELD, MISSOURI 65801	
	DECIMAL TOL. ± 0.015 [0.38]	DD SERIES
ANGULAR TOL. $\pm 5^\circ$	DATE 5-07-09	DRAWING NUMBER SK10698
TITLE FC6026D2AL		DRAWN BY B SHELEDDY APPROVED BY R WILLIAMS
REV. NC		REV.