

SK10857

THIS DRAWING CONTAINS INFORMATION PROPRIETARY TO POSITRONIC IND. INC. ANY REPRODUCTION, DISCLOSURE OR USE OF THIS DRAWING IS EXPRESSLY PROHIBITED, EXCEPT AS POSITRONIC IND. INC. MAY OTHERWISE AGREE IN WRITING.

DATE	REV	REVISION RECORD	APP	DR	CK
6-23-09	NC	ECO 31215	TK	TK	TK
8-5-09	A	ECO 31397	RCW	TK	TK

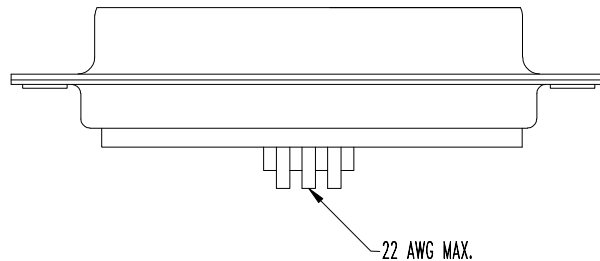
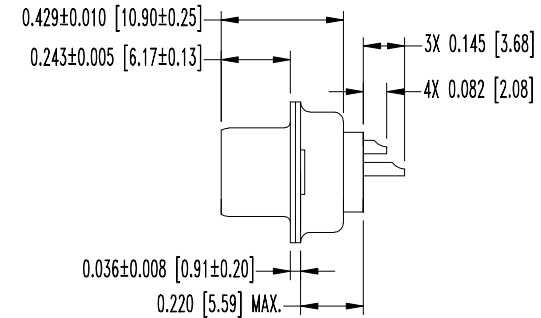
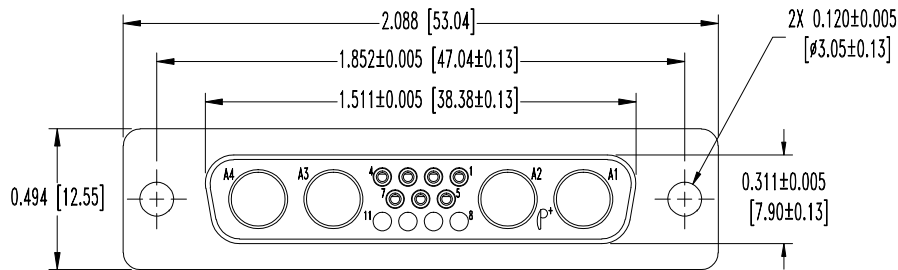

NOTES:

- MATERIALS AND FINISHES:
 INSULATOR: GLASS FILLED POLYESTER PER MIL-M-24519, BLUE.
 CONTACTS: BRASS, GOLD FLASH OVER NICKEL PLATE.
 SHELLS: STEEL, ZINC PLATED WITH DICHROMATE SEAL.
- ELECTRICAL CHARACTERISTICS:
 SIGNAL CONTACTS: CONTACT CURRENT RATING: 10 AMPERES NOMINAL.
 INITIAL CONTACT RESISTANCE: 0.008 OHMS MAXIMUM.
 INSULATOR RESISTANCE: 5 G OHMS.
 TEMPERATURE RANGE: -55°C TO +125°C.
- CONNECTORS ARE RoHS COMPLIANT PER RoHS DIRECTIVE 2002/95/EC OF 27 JAN. 2003.
- DIMENSIONS ARE IN INCHES [MILLIMETERS].

		POSITRONIC INDUSTRIES INC. SPRINGFIELD, MISSOURI 65801	
		SCALE: N.T.S.	DRAWN BY: T.KEPLEY APPROVED BY: TK
DECIMAL TOL. ± 0.015 [0.38]	QB SERIES	TITLE: QB15W4S210000/AA	
ANGULAR TOL. ± 5°	DATE: 6-23-09	DRAWING NUMBER: SK10857	REV.: NC