

SK9000

POSITRONIC INDUSTRIES BELIEVES THE DATA ON THIS DRAWING TO BE RELIABLE. SINCE THE TECHNICAL INFORMATION IS GIVEN FREE OF CHARGE, THE USER EMPLOYS SUCH INFORMATION AT HIS OWN DISCRETION AND RISK. POSITRONIC INDUSTRIES ASSUMES NO RESPONSIBILITY FOR RESULTS OBTAINED OR DAMAGES INCURRED FROM USE OF SUCH INFORMATION IN WHOLE OR IN PART.

DATE	REV	REVISION RECORD	APP	DR	CK
10-17-07	NC	ECO 28542	TK	YK	COLE

ACCEPTS 3/32 HEX DRIVER OR ALLEN WRENCH

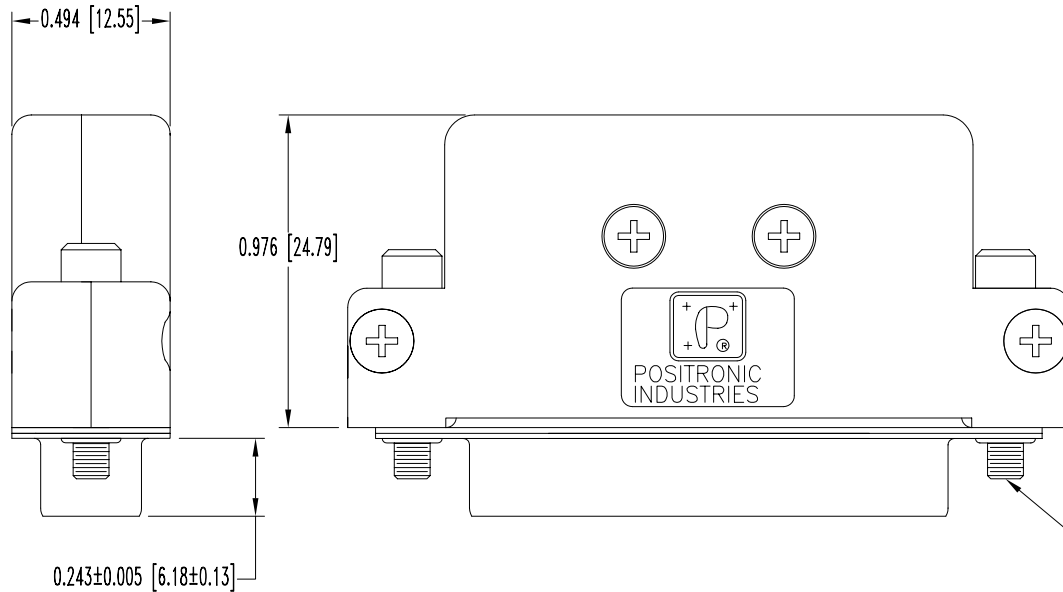
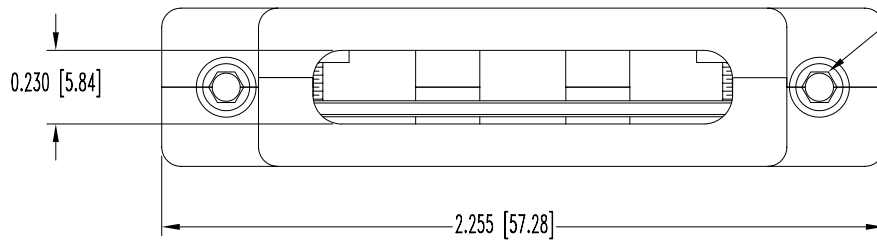

2X ROTATING MALE JACKSCREWS
4-40 UNC-2B THREADS

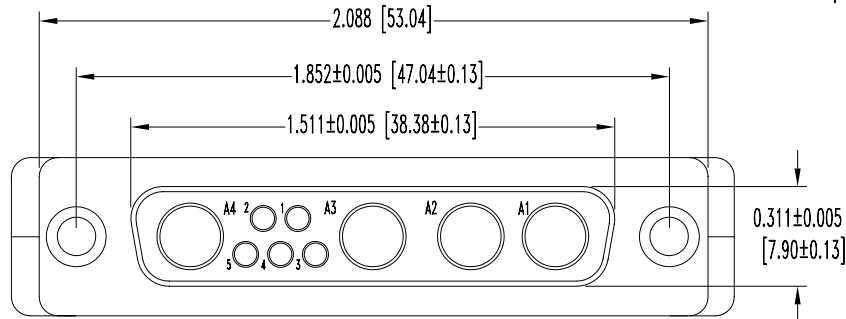

NOTES:

- MATERIAL AND FINISHES:
 INSULATOR: GLASS FILLED POLYESTER PER MIL-M-24519, UL 94V-0, COLOR BLUE.
 SHELLS: STEEL, ZINC FINISH WITH CHROMATE SEAL.
 SPACERS: STEEL, ZINC FINISH WITH CHROMATE SEAL.
 HOOD AND COVER: GLASS FILLED POLYESTER, COLOR BLUE.
 JACKSCREWS: STEEL, ZINC FINISH WITH CHROMATE SEAL.
 COVER SCREWS: STAINLESS STEEL, PASSIVATED.
 CABLE CLAMP: STEEL, NICKEL FINISH.
 CABLE CLAMP SCREWS: BRASS, ZINC FINISH WITH CHROMATE SEAL.
- ELECTRICAL CHARACTERISTICS
 INSULATOR RESISTANCE: 5 G OHMS.
 WORKING VOLTAGE: 300 V rms.
- REMOVABLE CONTACTS (ORDERED SEPARATELY).
 FOR GOLD FLASH OVER NICKEL FINISH USE FC40**D/AA-1817.0 (2 EACH) AND FC6020D/AA (2 EACH) CONTACTS.
 FOR 0.000030 [0.75µ] GOLD OVER NICKEL FINISH USE FC40**D/AA-14-1817.0 (2 EACH) AND FC6020D/AA-14 (2 EACH) CONTACTS.
- CONNECTORS ARE ROHS COMPLIANT PER ROHS DIRECTIVE 2002/95/EC OF 27 JAN 2003.
- DIMENSIONS ARE IN INCHES [MILLIMETERS].

	POSITRONIC INDUSTRIES INC. www.connectpositronic.com		FSCM 28198
	DECIMAL TOL. ± 0.015 [0.38]	SCALE N.T.S.	DRAWN BY YK
ANGULAR TOL. ± 5°	DATE 10-17-07	DRAWING NUMBER SK9000	REV. NC

QB SERIES

TITLE: QB9W4F00QH0/AA