



FEMALE ORDERING INFORMATION - CODE NUMBERING SYSTEM

Specify Complete Connector By Selecting An Option From Step 1 Through 9

CABLE CONNECTORS

STEP	1	2	3	4	5	6	7	8	9	10
EXAMPLE	QB	7W2	S	0	0	Q	H	0	/AA	-14
STEP 1 - BASIC SERIES QB Series										STEP 10 - SPECIAL OPTIONS FOR SPECIAL OPTIONS, SEE SPECIAL OPTIONS APPENDIX ON PAGE 89.
STEP 2 - CONNECTOR VARIANTS 7W2 9W4										STEP 9 - ENVIRONMENTAL COMPLIANCE OPTIONS /AA - Compliant per EU Directive 2002/95/EC (RoHS) Note: This step should be included to create a standard part number. Example: QB7W2S00QH0/AA
STEP 3 - CONNECTOR GENDER S - Female PosiBand Closed Entry Signal Contacts Open Entry Signal Contacts are available and can be ordered separately, see page 73.										STEP 8 - SHELL OPTIONS 0 - Zinc Plated, with Chromate Seal. S - Stainless Steel, passivated. X - Tin Plated.
STEP 4 - CONTACT TERMINATION 0 - Connector ordered without contacts. Order signal and power contacts separately. See page 54 for contact part numbers. 1 - Signal contacts, 20 AWG-24 AWG [0.5mm ² -0.25mm ²]. 11 - Signal contacts, 20 AWG-24 AWG [0.5mm ² -0.25mm ²] with FC4012D-1817.0 power contacts. 12 - Signal contacts, 20 AWG-24 AWG [0.5mm ² -0.25mm ²] with FC4008D-1817.0 power contacts.										STEP 7 - LOCKING AND POLARIZING SYSTEMS H - Rotating male jackscrew with internal hex for 3/32 hex drives.
STEP 5 - MOUNTING STYLE 0 - None										STEP 6 - HOODS Q - Hood, Top Opening, Plastic

For crimping information and crimp tools, see Application Tools section, pages 81-89.

QB SERIES

NOTE: Once you have made a connector selection, contact Technical Sales if you would like to receive a drawing in DXF, PDF format or a 3-dimensional IGES, STEP, or SOLIDWORKS file.

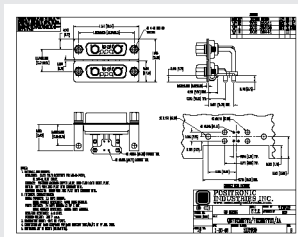

SK Drawing



3-dimensional model

Contact Technical Sales for ordering information for cable versions of the 5W5 and 15W4 variants.



Positronic Industries
connectpositronic.com

COMBO-D CONNECTOR SAVERS GENDER CHANGERS

Combo-D
D-Sub

**Professional Quality Connectors
ACBDP Series
Size 20 "Open Entry" or
PosiBand® "Closed Entry"
Contact Design**

**Industrial /Military Quality
Connectors - ACBMP Series
Size 20 PosiBand®
"Closed Entry" Contact Design
Connector Saver**

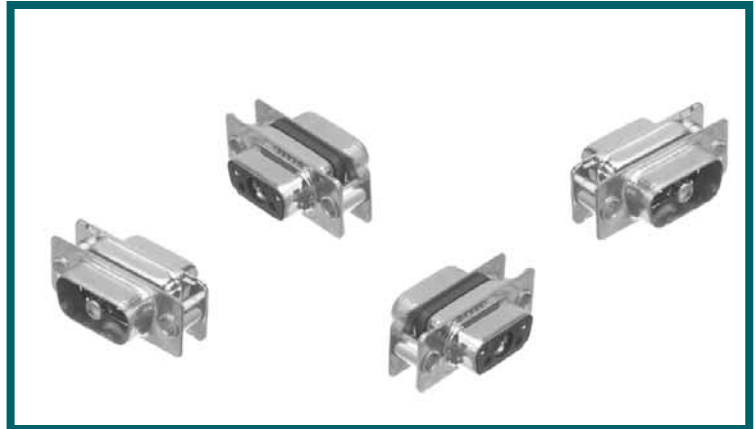

ACBDP and ACBMP series connectors are suitable for use in any applications requiring high performance characteristic. The normal density ACBDP and ACBMP series are available in standard Combo-D connector variants.

ACBDP and ACBMP series connectors utilize precision machined contacts for strength and durability. The ACBDP female contact features a rugged "Open Entry" design or PosiBand "Closed Entry" design for even higher reliability. ACBMP connectors features PosiBand "Closed Entry" contacts and military contact plating.

ACBDP and ACBMP series connectors can be mated to a connector which would normally experience high numbers of mating cycles. The

ACBDP/ACBMP connector can be easily replaced, "Saving" a connector which is not easily replaced.

These connectors can also be used as a "gender changer". Connector Savers are also available in standard and high density D-subminiature versions, please consult our Professional, Industrial and Military Performance D-subminiature Connectors catalog for more information.

For high density 8W2, 19W1 and 45W2 adapter variants contact Technical Sales.



**For RoHS options
see page 60.**

CONNECTOR SAVERS

TECHNICAL CHARACTERISTICS

MATERIALS AND FINISHES:

Insulator: Glass filled polyester per MIL-M-24519 UL 94V-0, blue color.

SIGNAL CONTACTS

ACBDP Series: Precision machined high tensile copper alloy open entry design.

ACBMP Series: Precision machined copper alloy *PosiBand closed entry design.*

POWER CONTACTS: Precision machined copper alloy closed entry design.

Contact Plating:

ACBDP Series: Gold flash over nickel plate.

ACBMP Series: 0.000050 [1.27µ] gold over nickel plate.

Shells:

Steel or brass with tin plate; zinc plate with chromate seal; stainless steel passivated. Other materials and finishes available upon request.

Jackscrew Systems: Brass or steel with zinc plate and chromate seal or clear zinc plate or tin plate; stainless steel, passivated.

Non-magnetic versions are available, contact Technical Sales.

MECHANICAL CHARACTERISTICS:

FIXED CONTACTS:

Signal Contacts:

Size 20 contacts, male - 0.040 inch [1.02 mm] diameter. ACBDP series has female open entry contact or PosiBand closed entry contacts optional, see page 69 for details. ACBMP series offer female PosiBand closed entry contacts.

Power Contacts:

Size 8 contacts, male - 0.142 inch [3.61 mm] diameter. Female contact features Large Surface Area (L.S.A.) closed entry contact design utilizing BeCu mechanical retention member.

REMOVABLE CRIMP POWER CONTACTS
CODE 11 AND 12

*1 CONTACTS ARE NOT SUPPLIED IN CONNECTOR AND NEED TO BE ORDERED SEPARATELY

***1 FEMALE CONTACT**

“CLOSED ENTRY” DESIGN, L.S.A.

*1 Note: Connectors can be kitted with all applicable crimp contacts, contact Technical Sales for connector part number.

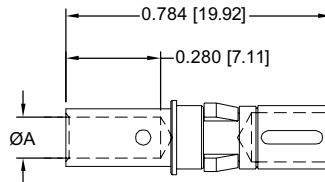
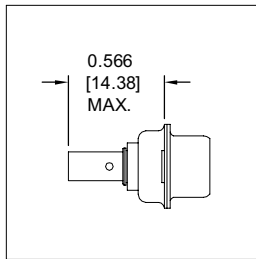

PART NUMBER	WIRE SIZE [AWG] mm ²	ØA
FC4012D/AA-1817.0	12 [4.0]	0.101 [2.57]
FC4008D/AA-1817.0	8 [10.0]	0.181 [4.60]

MATERIAL: Copper alloy.

PLATING: (choose contact plating based on individual application requirements)

STANDARD FINISH: Gold flash over nickel plate.

OPTIONAL FINISHES: 0.000030 [0.76 µ] gold over nickel by adding “-14” suffix onto part number. Example: FC4012D/AA-14-1817.0.
0.000050 inch [1.27µ] gold over nickel by adding “-15” suffix onto part number. Example: FC4008D/AA-15-1817.0

*1 **NOTE:** Female contacts feature Large Surface Area (L.S.A.) closed entry contact design which provides maximum mating surfaces between male and female contact and reduced contact resistance during operation.

For crimping information and crimp tools, see Application Tools section, page 81-89.

REMOVABLE CRIMP SIGNAL CONTACTS
CODE 0, 11 AND 12

*1 CONTACTS ARE NOT SUPPLIED IN CONNECTOR AND NEED TO BE ORDERED SEPARATELY

CLOSED CRIMP BARREL

FEMALE CONTACT

“CLOSED ENTRY” DESIGN

*1 Note: Connectors can be kitted with all applicable crimp contacts, contact Technical Sales for connector part number.

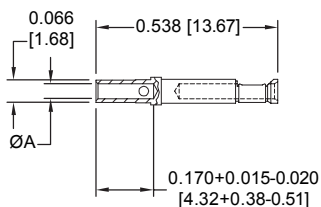

PART NUMBER	WIRE SIZE AWG/[mm ²]	AØ
FC6020D2/AA	20 / 22 / 24 [0.5/0.3/0.25]	0.045 [1.14]

MATERIAL: Copper alloy.

PLATING: (choose contact plating based on individual application requirements)

STANDARD FINISH: Gold flash over nickel plate.

OPTIONAL FINISHES: 0.000030 [0.76 µ] gold over nickel by adding “-14” suffix onto part number. Example: FC6020D/AA-14.
0.000050 inch [1.27µ] gold over nickel by adding “-15” suffix onto part number. Example: Example: FC6020D/AA-15.

For crimping information and crimp tools, see Application Tools section, page 81-89.

POSITRONIC INDUSTRIES

Connector Excellence[®]

Connector Families

Power

D-SUBMINIATURE

Circular

RECTANGULAR

Hermetic

THERMOCOUPLE

POSITRONIC INDUSTRIES, INC.

423 N Campbell Avenue • PO Box 8247 • Springfield, MO 65801
Tel (417) 866-2322 • Fax (417) 866-4115 • Toll Free (800) 641-4054
info@connectpositronic.com

POSITRONIC INDUSTRIES, S.A.S.

Zone Industrielle d'Engachies • 46 Route d'Engachies
France 32020 Auch Cedex 9
Telephone 33 5 62 63 44 91 • Fax 33 5 62 63 51 17
contact@connectpositronic.com

POSITRONIC ASIA PTE LTD.

3014A Ubi Road 1 #07-01 • Singapore 408703
Telephone (65) 6842 1419 • Fax (65) 6842 1421
singapore@connectpositronic.com



POSITRONIC[®]
GLOBAL *Connector* SOLUTIONS

Quality Solutions

Reliable Service