



UNIQUE FEATURE SECTION



Positronic Industries is **known** around the world **for offering** our customers **flexibility** when choosing connectors.

In addition to allowing **customers** to **create** part numbers for **particular applications**, Positronic offers a **wide variety** of features and accessories within our products.

Positronic is **able** to modify existing products **to meet unique customer requirements**. We are also eager to develop **custom connectors** to customer requirements. If you do not find what you need in this catalog, please contact us for **assistance**.

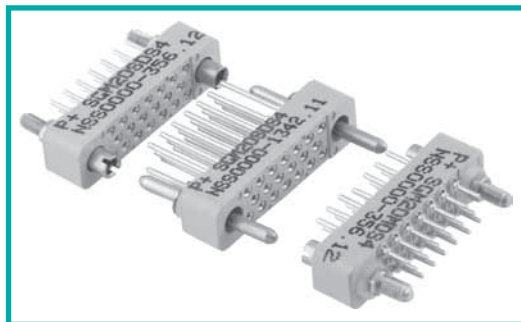

**LOW PROFILE SPACE SAVING  
HIGH RELIABILITY MEZZANINE CONNECTOR**  
SGM SERIES

*SGM connectors can be **used to stack multiple printed circuit boards** in applications requiring rugged, high density connectors.*

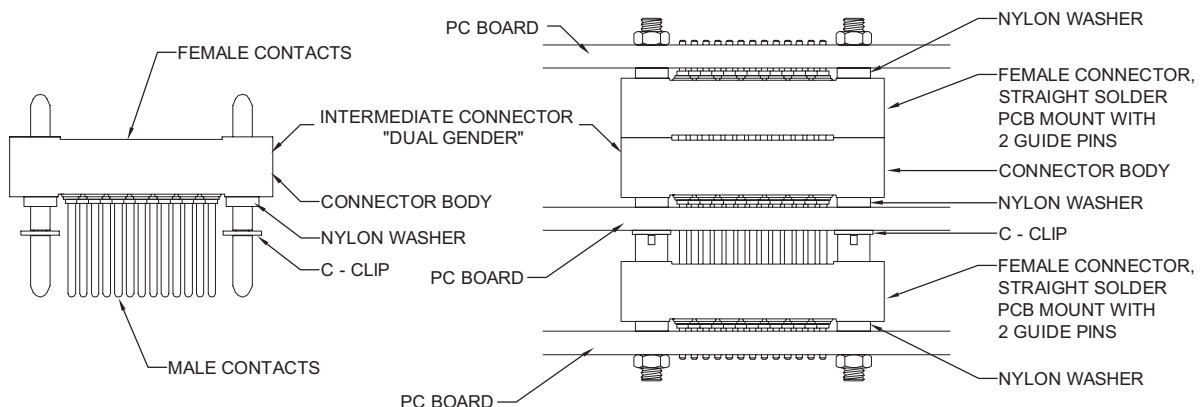

FOR DETAILED INFORMATION AND OPTIONS, CONTACT TECHNICAL SALES



## CUSTOMER SPECIFIED CONTACT TERMINATION LENGTH

*Positronic can supply High Density Rectangular connectors with customer specified termination lengths. We have a wide variety of options available.*

### STRAIGHT PRINTED BOARD MOUNT

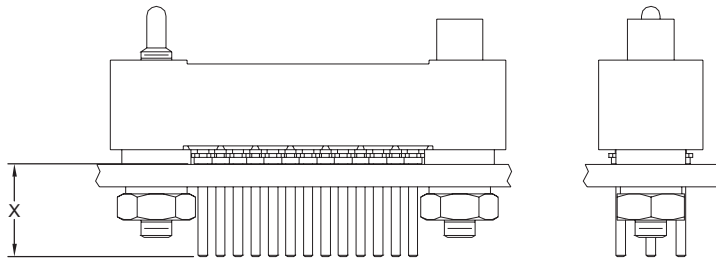

### RIGHT ANGLE (90°) PRINTED BOARD MOUNT

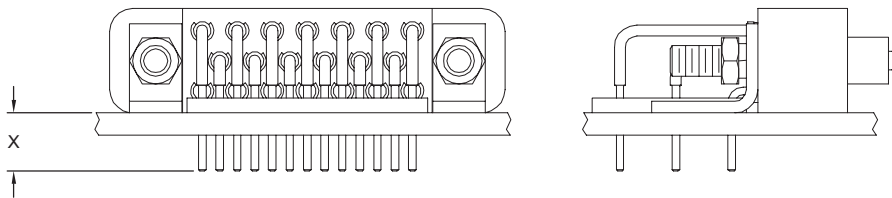

**“X” contact termination lengths can be custom designed to fit your application requirements.**

**CONTACT TECHNICAL SALES FOR MORE INFORMATION!**

## FLUSH PANEL CONNECTOR MOUNTING BRACKETS

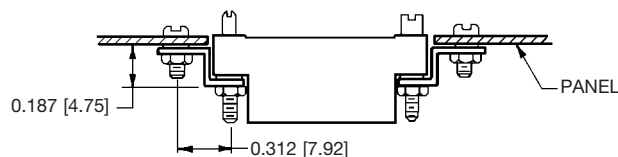

**PART NUMBER 80217-0**

**POLARIZATION & CODING (KEYING) OPTIONS**

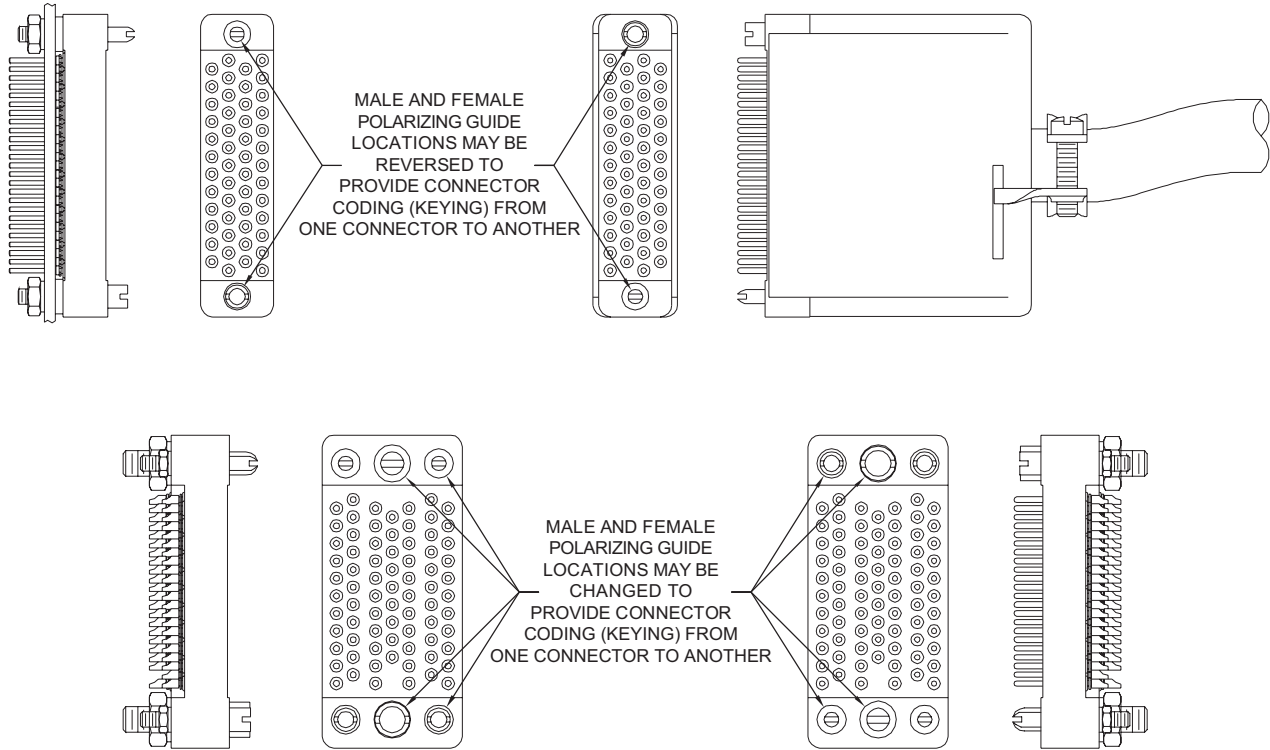

**A C C E S S O R I E S S E C T I O N**

**PANEL CUT-OUT DIMENSIONS**  
FOR USE WITH SGM C OR SGM SERIES CONNECTORS

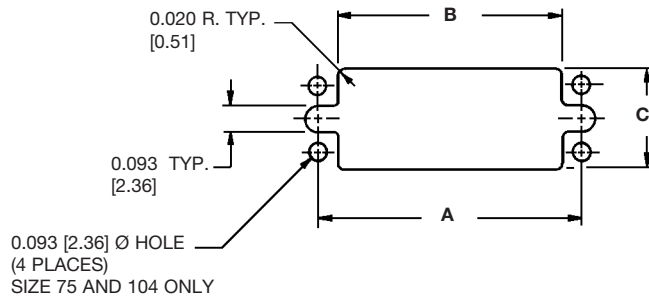

SIZE	A	B MIN.	C MIN.
4	0.562 [14.27]	0.390 [9.91]	0.215 [5.46]
5	0.482 [12.24]	0.315 [8.00]	0.215 [5.46]
7	0.562 [14.27]	0.397 [10.08]	0.215 [5.46]
9	0.656 [16.66]	0.495 [12.57]	0.215 [5.46]
11	0.531 [13.49]	0.401 [10.19]	0.285 [7.24]
14	0.625 [15.88]	0.510 [12.95]	0.285 [7.24]
20	0.814 [20.68]	0.700 [17.78]	0.285 [7.24]
26	1.000 [25.40]	0.885 [22.48]	0.285 [7.24]
29	1.094 [27.79]	0.959 [24.36]	0.285 [7.24]
34	1.032 [26.21]	0.867 [22.02]	0.395 [10.03]
44	1.281 [32.54]	1.105 [28.07]	0.395 [10.03]
50	1.408 [35.76]	1.235 [31.37]	0.395 [10.03]
75	1.375 [34.93]	1.145 [29.08]	0.755 [19.18]
104	1.750 [44.45]	1.520 [37.47]	0.755 [19.18]

POSITRONIC INDUSTRIES

*Connector Excellence*<sup>®</sup>

**Connector Families**

**Power**

D-SUBMINIATURE

**Circular**

RECTANGULAR

**Hermetic**

**THERMOCOUPLE**

**POSITRONIC INDUSTRIES, INC.**

423 N Campbell Avenue • PO Box 8247 • Springfield, MO 65801  
Tel (417) 866-2322 • Fax (417) 866-4115 • Toll Free (800) 641-4054  
info@connectpositronic.com

**POSITRONIC INDUSTRIES, S.A.S.**

Zone Industrielle d'Engachies • 46 Route d'Engachies  
France 32020 Auch Cedex 9  
Telephone 33 5 62 63 44 91 • Fax 33 5 62 63 51 17  
contact@connectpositronic.com

**POSITRONIC ASIA PTE LTD.**

3014A Ubi Road 1 #07-01 • Singapore 408703  
Telephone (65) 6842 1419 • Fax (65) 6842 1421  
singapore@connectpositronic.com



**POSITRONIC**<sup>®</sup>  
GLOBAL *Connector* SOLUTIONS

Quality Solutions  
**Reliable Service**