

POSITRONIC INDUSTRIES BELIEVES THE DATA ON THIS DRAWING TO BE RELIABLE. SINCE THE TECHNICAL INFORMATION IS GIVEN FREE OF CHARGE, THE USER EMPLOYS SUCH INFORMATION AT HIS OWN DISCRETION AND RISK. POSITRONIC INDUSTRIES ASSUMES NO RESPONSIBILITY FOR RESULTS OBTAINED OR DAMAGES INCURRED FROM USE OF SUCH INFORMATION IN WHOLE OR IN PART.

DATE	REV	REVISION RECORD	APP	DR	CK
5-20-04	NC	ECO 22457	RCW	YK	COLE
8-1-05	A	ECO 24437		TH	

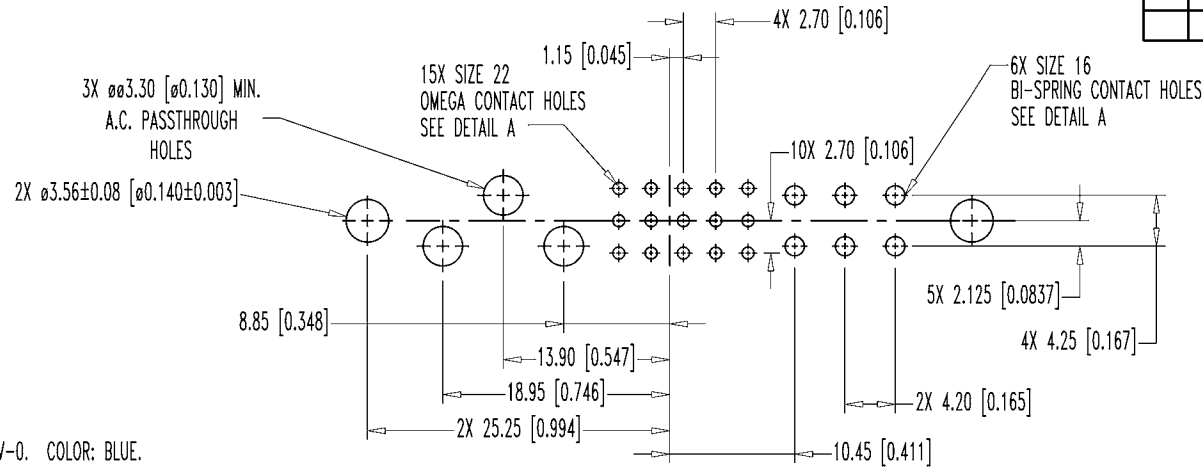

NOTES:

1. MATERIALS AND FINISHES:

INSULATOR: GLASS FILLED POLYESTER, UL 94V-0. COLOR: BLUE.
 SIZE 16 CONTACTS: HIGH CONDUCTIVITY PRECISION MACHINED COPPER ALLOY WITH GOLD FLASH OVER NICKEL.
 SIZE 22 CONTACTS: PRECISION MACHINED COPPER ALLOY WITH GOLD FLASH OVER NICKEL.

2. ELECTRICAL CHARACTERISTICS:

CONTACT CURRENT RATING:

SIZE 16 POWER CONTACTS:
 POSITIONS 22, 23 AND 24: 45 AMPERES CONTINUOUS, ALL CONTACTS UNDER LOAD.

POSITIONS 1-6: 35 AMPERES CONTINUOUS, ALL CONTACTS UNDER LOAD.

SIZE 22 SIGNAL CONTACTS: 3 AMPERES NOMINAL.
 INITIAL CONTACT RESISTANCE; PER IEC 512-2, TEST 2b.

SIZE 16 CONTACT: 0.0007 OHMS MAXIMUM.

SIZE 22 CONTACT: 0.004 OHMS MAXIMUM.

INSULATOR RESISTANCE: 5 G OHMS PER IEC 512-2, TEST 3a.

VOLTAGE PROOF:

CONTACTS: 22, 23 AND 24: 3,000 V r.m.s.

CONTACTS: 1 THROUGH 6: 1,500 V r.m.s.

CONTACTS: 7 THROUGH 21: 1,000 V r.m.s.

CREEPAGE AND CLEARANCE

DISTANCE; MINIMUM:

CONTACT 24 TO CONTACT 22: 3.2 [0.126]

CONTACT 23 TO CONTACT 22: 3.2 [0.126]

CONTACT 24 TO SIGNAL CONTACTS: 6.4 [0.252]

CONTACT 23 TO SIGNAL CONTACTS: 6.4 [0.252]

CONTACT 24 TO CONTACT 23: 2.5 [0.098]

CONTACT 22 TO SIGNAL CONTACTS: 2.0 [0.079]

3. THIS MOS ALLOWS FOR CONNECTOR TO HAVE SPECIAL LOW PROFILE AC PASS THROUGH MOLDING.

4. WORKING TEMPERATURE: -55°C TO +125°C.

△ USE FC*N25-1565.0 CONTACTS ON CRIMP REMOVABLE POSITIONS, SEE CHART.

6. DIMENSIONS ARE IN MILLIMETERS [INCHES].

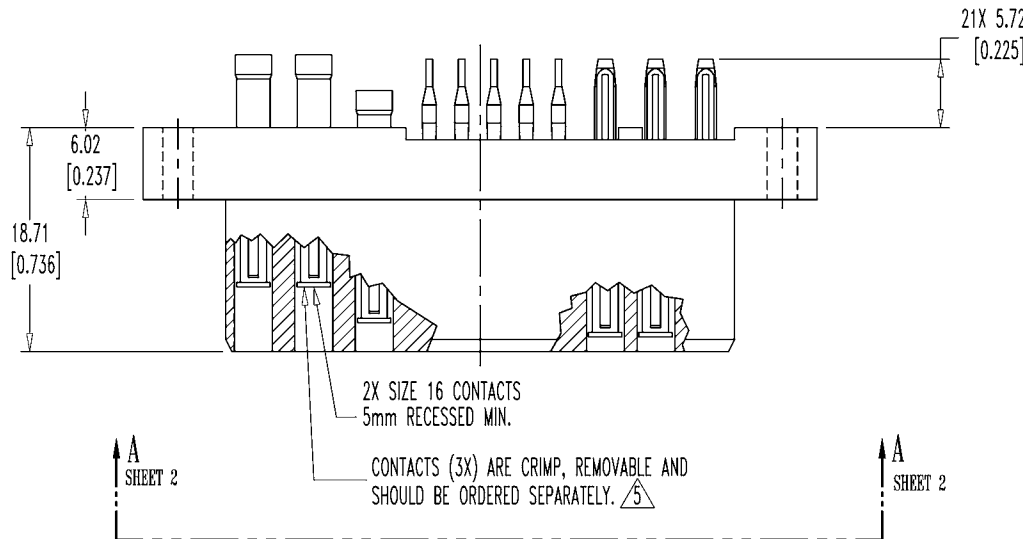

A
SHEET 2

A
SHEET 2

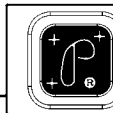

POSITRONIC INDUSTRIES INC.
www.connectpositronic.com

PART NUMBER	WIRE SIZE mm ² /[awg]
FC112N2S-1565.0	4.0/[12]
FC114N2-1565.0	2.5-1.5/[14-16]
FC116N2-1565.0	1.5-1.0/[16-18]

DECIMAL TOL. ± 0.38 [0.015]	SCALE N.T.S.	DRAWN BY YK
ANGULAR TOL. ± 5°	APPROVED BY RCW	
TITLE PCI SERIES		
DATE 5-20-04		
DRAWING NUMBER SK5480		
REV. A		
PCIB24W9F9300A1-246.5		
SHEET 1 OF 2		

POSITRONIC INDUSTRIES BELIEVES THE DATA ON THIS DRAWING TO BE RELIABLE, SINCE THE TECHNICAL INFORMATION IS GIVEN FREE OF CHARGE, THE USER EMPLOYS SUCH INFORMATION AT HIS OWN DISCRETION AND RISK. POSITRONIC INDUSTRIES ASSUMES NO RESPONSIBILITY FOR RESULTS OBTAINED OR DAMAGES INCURRED FROM USE OF SUCH INFORMATION IN WHOLE OR IN PART.

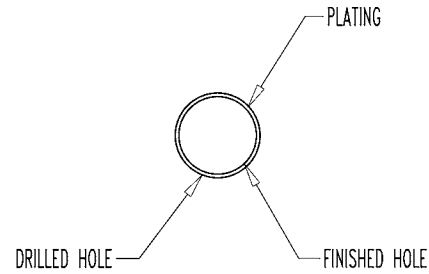

PRESS FIT CONTACT HOLES SEE SK6370

DETAIL A

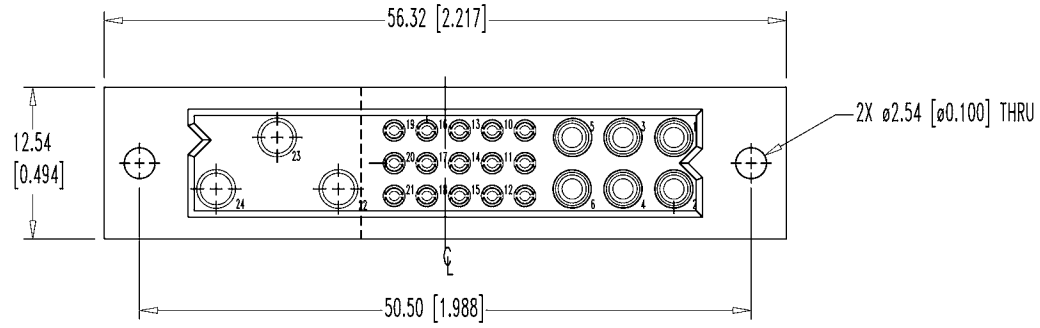

VIEW A-A