

POSITRONIC INDUSTRIES BELIEVES THE DATA ON THIS DRAWING TO BE RELIABLE, SINCE THE TECHNICAL INFORMATION IS GIVEN FREE OF CHARGE, THE USER EMPLOYS SUCH INFORMATION AT HIS OWN DISCRETION AND RISK. POSITRONIC INDUSTRIES ASSUMES NO RESPONSIBILITY FOR RESULTS OBTAINED OR DAMAGES INCURRED FROM USE OF SUCH INFORMATION IN WHOLE OR IN PART.

DATE	REV	REVISION RECORD	APP	DR	CK
10-9-07	NC	ECO 28499	RCW	YK	COLE

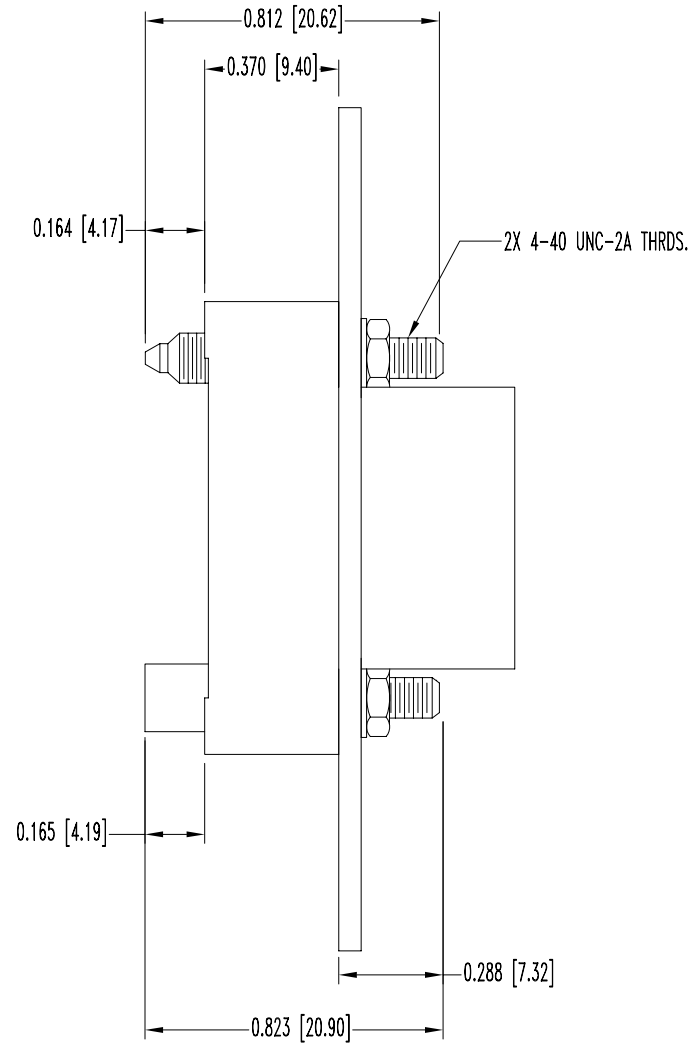
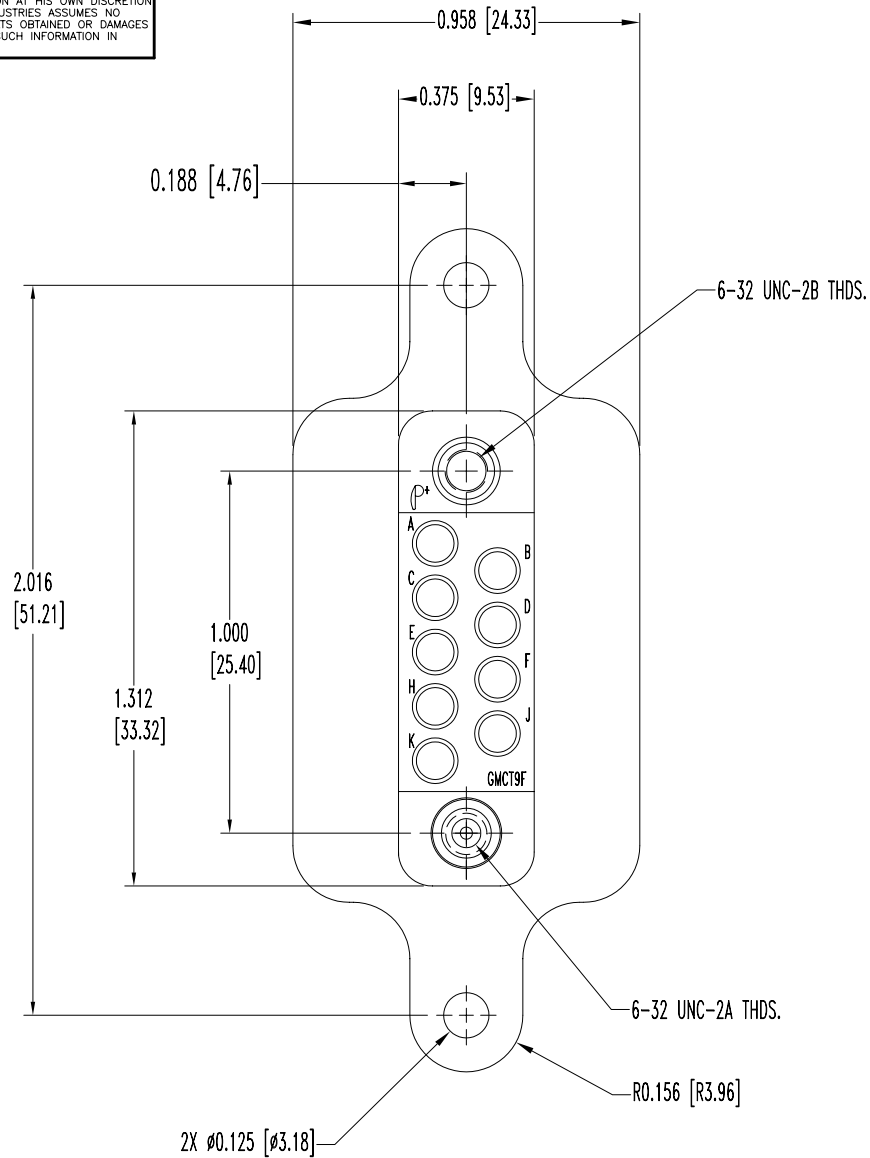

NOTES:

1. MATERIALS AND FINISHES:

- INSULATOR: GLASS FILLED DAP PER ASTM-D-5948 TYPE SDG-F, GREY COLOR.
- MOUNTING PLATE: ALUMINUM, YELLOW ANODIZE.
- JACKSCREWS: STAINLESS STEEL, PASSIVATED.
- HEX NUT: BRASS, ZINC PLATE WITH CHROMATE SEAL.
- LOCKWASHERS: BRONZE, ZINC PLATE WITH CHROMATE SEAL.

2. ELECTRICAL CHARACTERISTICS:

- INSULATOR RESISTANCE: 5 G OHMS MINIMUM.
- WORKING VOLTAGE: 500 V.AC [rms].

3. WORKING TEMPERATURE: -65° TO +150°C.

4. DIMENSIONS ARE IN INCHES [MILLIMETERS].

	<b>POSITRONIC INDUSTRIES INC.</b> www.connectpositronic.com		FSCM 28198
	DECIMAL TOL. $\pm 0.015$ [0.38]	TITLE <b>GMCT9F0TH000</b>	SCALE N.T.S.
ANGULAR TOL. $\pm 5^\circ$	DATE 10-9-07	DRAWING NUMBER SK8983	APPROVED BY RCW
REV.			NC