

POSITRONIC INDUSTRIES BELIEVES THE DATA ON THIS DRAWING TO BE RELIABLE, SINCE THE TECHNICAL INFORMATION IS GIVEN FREE OF CHARGE, THE USER EMPLOYS SUCH INFORMATION AT HIS OWN DISCRETION AND RISK. POSITRONIC INDUSTRIES ASSUMES NO RESPONSIBILITY FOR RESULTS OBTAINED OR DAMAGES INCURRED FROM USE OF SUCH INFORMATION IN WHOLE OR IN PART.

DATE	REV	REVISION RECORD	APP	DR	CK
2-28-01	A	ECO 17391	TK	JLG	MG
9-4-01	B	ECO 18259	RCW	ME	TK
6-2-03	C	ECO 20993	RCW	MEG	TK
8-17-05	D	ECO 24483		TH	

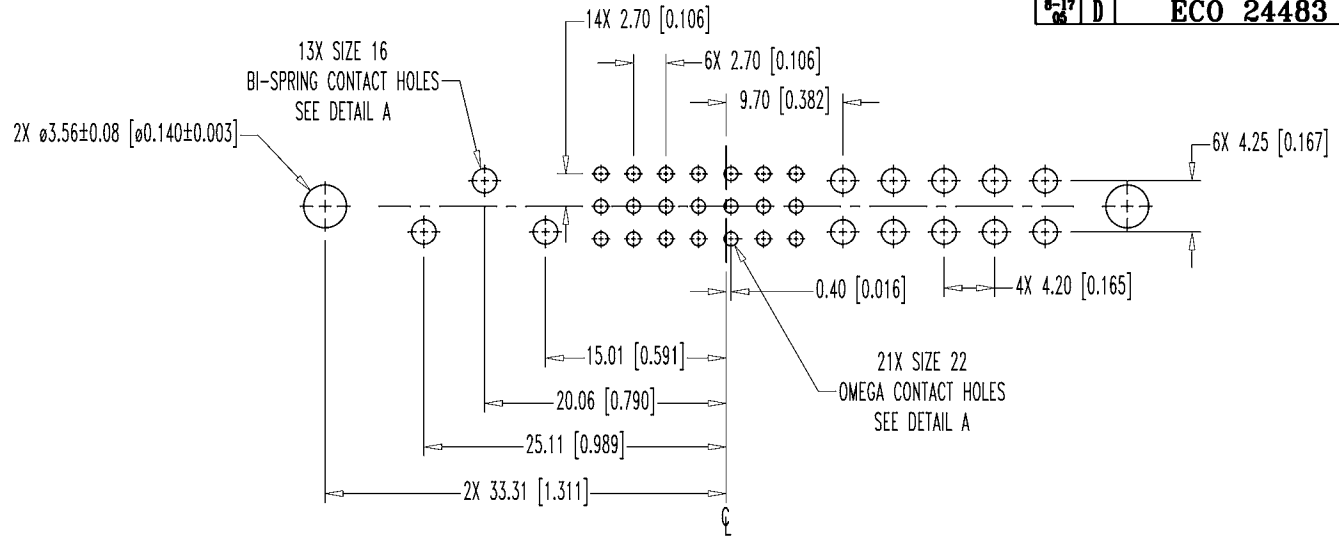

NOTES:

1. MATERIALS AND FINISHES:

INSULATOR: GLASS FILLED POLYESTER, UL 94V-0. COLOR: BLUE.
 ALIGNMENT BAR: GLASS FILLED POLYESTER, UL 94V-0. COLOR: BLUE.
 SIZE 16 CONTACTS: HIGH CONDUCTIVITY PRECISION MACHINED COPPER ALLOY WITH GOLD FLASH OVER NICKEL.
 SIZE 22 CONTACTS: PRECISION MACHINED COPPER ALLOY WITH GOLD FLASH OVER NICKEL.

2. ELECTRICAL CHARACTERISTICS:

CREEPAGE AND CLEARANCE DISTANCE; MINIMUM:
 CONTACT 34 TO CONTACT 32: 3.2 [0.126]
 CONTACT 33 TO CONTACT 32: 3.2 [0.126]
 CONTACT 34 TO SIGNAL CONTACTS: 6.4 [0.252]
 CONTACT 33 TO SIGNAL CONTACTS: 6.4 [0.252]
 CONTACT 34 TO CONTACT 33: 2.5 [0.098]
 CONTACT 32 TO SIGNAL CONTACTS: 2.0 [0.079]

CONTACT CURRENT RATING:

SIZE 16 CONTACTS: POSITIONS 32, 33, 34 40 AMPERES CONTINUOUS ALL CONTACTS UNDER LOAD.
 1-10 28 AMPERES CONTINUOUS ALL CONTACTS UNDER LOAD.
 SIZE 22 CONTACTS: 3 AMPERES NOMINAL.

INITIAL CONTACT RESISTANCE:

SIZE 16 CONTACTS: 0.0007 OHMS. MAX. PER IEC 512-2, TEST 2b.
 SIZE 22 CONTACTS: 0.004 OHMS MAX.

INSULATION RESISTANCE: 5 G OHMS PER IEC 512-2, TEST 3a, METHOD A.

WORKING TEMPERATURE: -55°C TO +125°C.

3. DIMENSIONS ARE IN MILLIMETERS [INCHES].

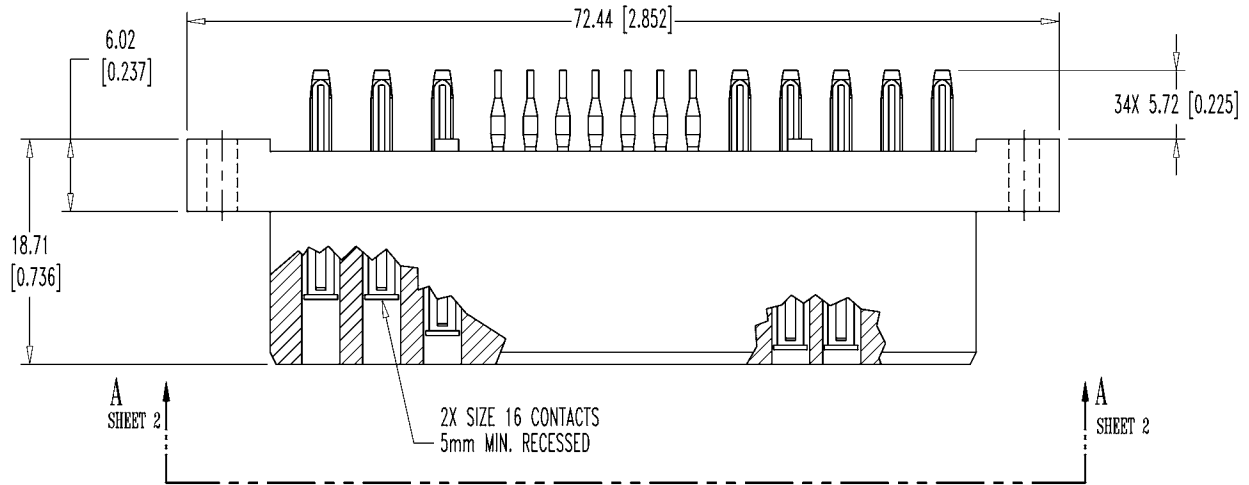

		POSITRONIC INDUSTRIES INC. www.connectpositronic.com	
		PCI SERIES 13 SIZE 16, 21 SIZE 22	SCALE N.T.S.
DECIMAL TOL. ± 0.38 [0.015]	TITLE PCIM34W13F9300A1		
ANGULAR TOL. ± 3°	DATE 6-2-03	DRAWING NUMBER SK3491	REV. SHEET 1 OF 2 D

POSITRONIC INDUSTRIES BELIEVES THE DATA ON THIS DRAWING TO BE RELIABLE, SINCE THE TECHNICAL INFORMATION IS GIVEN FREE OF CHARGE, THE USER EMPLOYS SUCH INFORMATION AT HIS OWN DISCRETION AND RISK. POSITRONIC INDUSTRIES ASSUMES NO RESPONSIBILITY FOR RESULTS OBTAINED OR DAMAGES INCURRED FROM USE OF SUCH INFORMATION IN WHOLE OR IN PART.

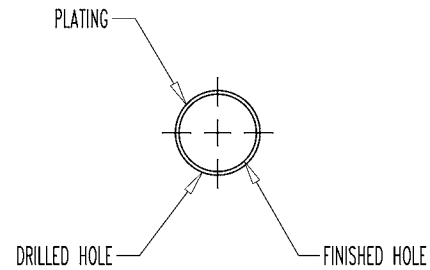

PRESS FIT CONTACT HOLES SEE SK6370
DETAIL A

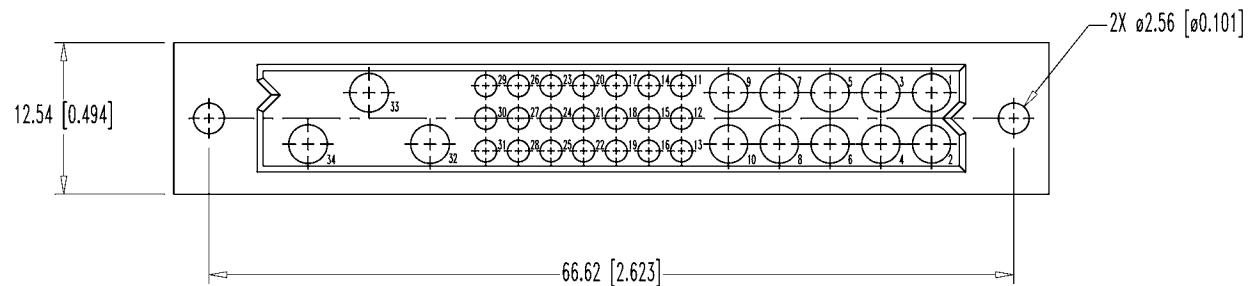

VIEW A-A