

SK8747

POSITRONIC INDUSTRIES BELIEVES THE DATA ON THIS DRAWING TO BE RELIABLE. SINCE THE TECHNICAL INFORMATION IS GIVEN FREE OF CHARGE, THE USER EMPLOYS SUCH INFORMATION AT HIS OWN DISCRETION AND RISK. POSITRONIC INDUSTRIES ASSUMES NO RESPONSIBILITY FOR RESULTS OBTAINED OR DAMAGES INCURRED FROM USE OF SUCH INFORMATION IN WHOLE OR IN PART.

DATE	REV	REVISION RECORD	APP	DR	CK
7-13-07	NC	ECO 28165	RCW	YK	TK

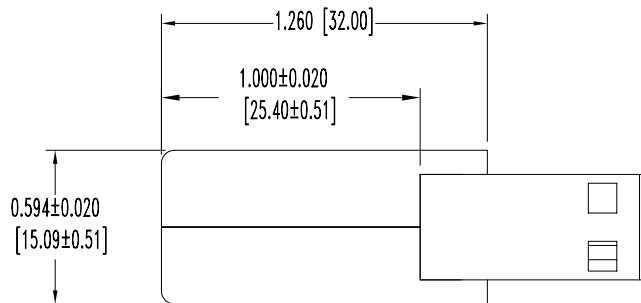
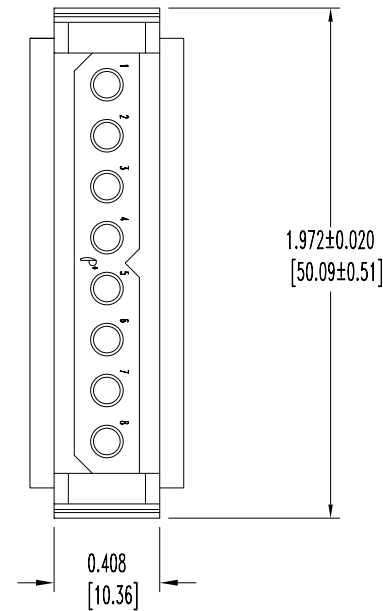
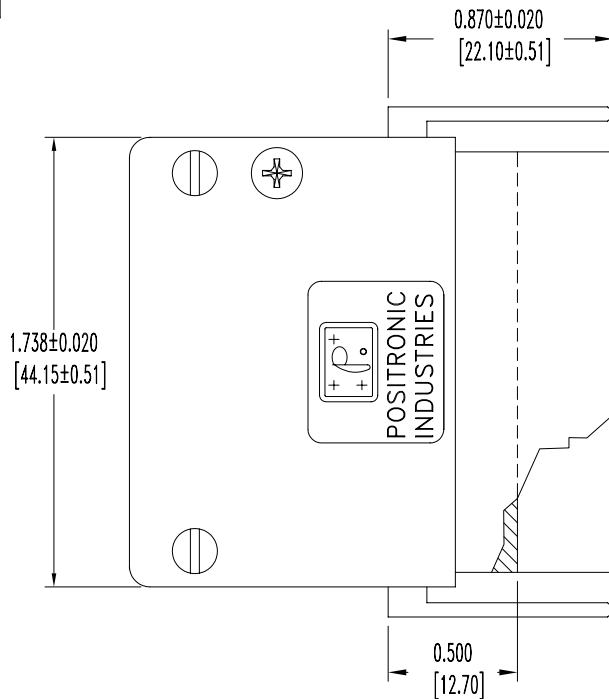

NOTES:

1. MATERIALS AND FINISHES:

INSULATOR: GLASS-FILLED POLYESTER, UL 94V-0, BLUE COLOR.

HOOD: GLASS FILLED POLYESTER, UL 94 V-0, COLOR BLUE.

HOOD SCREWS: STEEL, ZINC PLATE CHROMATE SEAL.

CABLE CLAMP: STEEL, NICKEL PLATE.

CABLE CLAMP SCREWS: BRASS, ZINC PLATE WITH CHROMATE SEAL.

2. ELECTRICAL CHARACTERISTICS:

INSULATION RESISTANCE: 5 G OHMS PER IEC 512-2, TEST 3a, METHOD A.

WORKING VOLTAGE: 600 VAC.

3. WORKING TEMPERATURE: -55°C TO +125°C.

4. CONNECTORS ARE ROHS COMPLIANT PER ROHS DIRECTIVE 2002/95/EC OF 27 JAN 2003.

5. DIMENSIONS ARE IN INCHES [MILLIMETERS].

	POSITRONIC INDUSTRIES INC. www.connectpositronic.com		FSCM 28198
	DECIMAL TOL. ± 0.015 [0.38]	PCS SERIES	SCALE N.T.S.
ANGULAR TOL. ± 5°	DATE 7-13-07	TITLE PLA08M7050/AA	APPROVED BY RCW
DRAWING NUMBER SK8747	REV. NC	DATE 7-13-07	