

SK7254

POSITRONIC INDUSTRIES BELIEVES THE DATA ON THIS DRAWING TO BE RELIABLE. SINCE THE TECHNICAL INFORMATION IS GIVEN FREE OF CHARGE, THE USER EMPLOYS SUCH INFORMATION AT HIS OWN DISCRETION AND RISK. POSITRONIC INDUSTRIES ASSUMES NO RESPONSIBILITY FOR RESULTS OBTAINED OR DAMAGES INCURRED FROM USE OF SUCH INFORMATION IN WHOLE OR IN PART.

DATE	REV	REVISION RECORD	APP	DR	CK
4-7-06	NC	ECO 25795		ME	

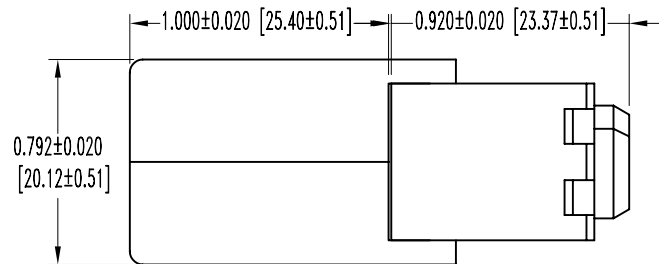
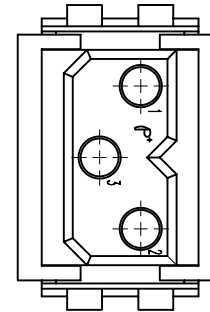
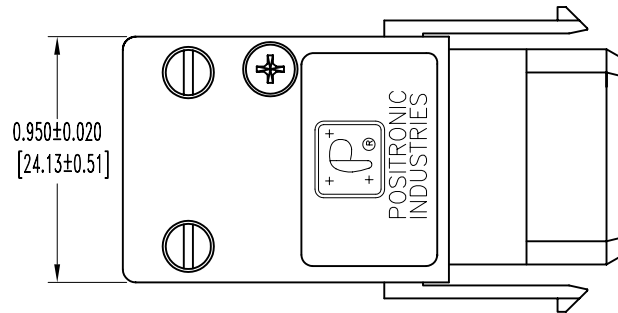

NOTES:

1. MATERIALS AND FINISHES:

INSULATOR: GLASS FILLED POLYESTER, UL 94V-0. COLOR BLUE.  
 HOOD: GLASS FILLED POLYESTER, UL 94V-0, COLOR BLUE.  
 SCREWS: STEEL, ZINC PLATE WITH CHROMATE SEAL.

2. ELECTRICAL CHARACTERISTICS:

INSULATOR RESISTANCE: 5 G. OHMS. PER IEC 512-2, TEST 3a.  
 WORKING VOLTAGE: 1,250 V. r.m.s.

3. CONNECTORS ARE ROHS COMPLIANT PER ROHS DIRECTIVE 2002/95/EC OF 27 JAN. 2003.

4. TEMPERATURE RANGE: -55°C TO 125°C.

5. DIMENSIONS ARE IN INCHES [MILLIMETERS].

 <b>POSITRONIC INDUSTRIES INC.</b> www.connectpositronic.com		PCS SERIES		SCALE	DRAWN BY
				N.T.S.	M. ENEA
DECIMAL TOL. $\pm 0.015$ [0.38]		TITLE PLB3W3F0050/AA			
ANGULAR TOL. $\pm 5^\circ$		DATE	DRAWING NUMBER	REV.	
		4-7-06	SK7254	NC	