

POSITRONIC INDUSTRIES BELIEVES THE DATA ON THIS DRAWING TO BE RELIABLE. SINCE THE TECHNICAL INFORMATION IS GIVEN FREE OF CHARGE, THE USER EMPLOYS SUCH INFORMATION AT HIS OWN DISCRETION AND RISK. POSITRONIC INDUSTRIES ASSUMES NO RESPONSIBILITY FOR RESULTS OBTAINED OR DAMAGES INCURRED FROM USE OF SUCH INFORMATION IN WHOLE OR IN PART.

DATE	REV	REVISION RECORD	APP	DR	CK
3-27-06	NC	ECO 25696		YK	

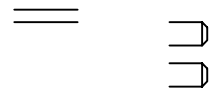

[7.1]

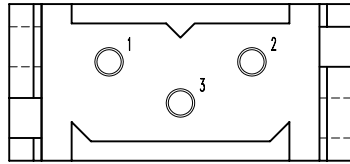
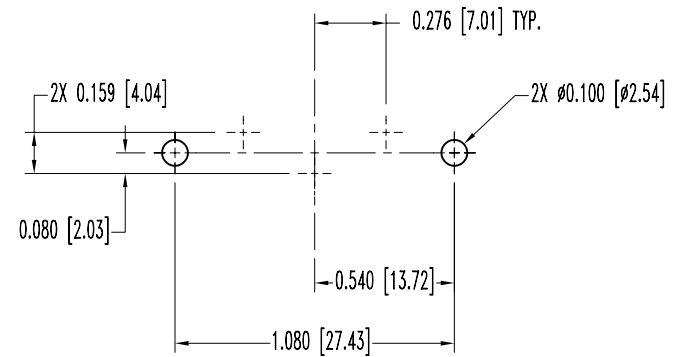
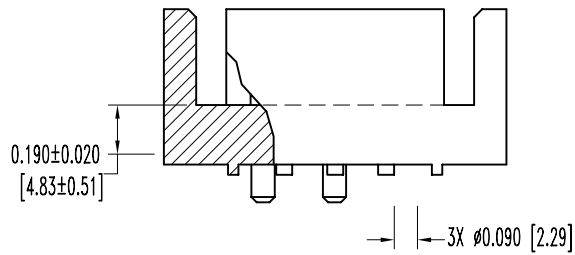

CONTACT HOLE

NOTES:

- MATERIALS AND FINISHES:
INSULATOR: GLASS FILLED POLYESTER, UL 94V-0.
CONTACTS: PRECISION MACHINED COPPER ALLOY WITH GOLD FLASH OVER NICKEL PLATE.
- ELECTRICAL CHARACTERISTICS:
CONTACT CURRENT RATING: 40 AMPERES CONTINUOUS, DERATED PER IEC 512-3, TEST 5b
INITIAL CONTACT RESISTANCE: 0.001 OHMS MAXIMUM, PER IEC 512-2, TEST 2b.
INSULATOR RESISTANCE: 5 G OHMS PER IEC 512-2, TEST 3a.
WORKING VOLTAGE: 1,250 V. r.m.s.
- TEMPERATURE RANGE: -55°C TO 125°C.
- CONNECTORS ARE ROHS COMPLIANT PER ROHS DIRECTIVE 2002/95/EC OF 27 JAN 2003.
- DIMENSIONS ARE IN INCHES [MILLIMETERS].

		POSITRONIC INDUSTRIES INC. www.connectpositronic.com	
	PCS SERIES	SCALE N.T.S.	DRAWN BY YK
DECIMAL TOL. ± 0.015 [0.38]	TITLE PLB3W3M300A1/AA		
ANGULAR TOL. ± 5°	DATE 3-27-06	DRAWING NUMBER SK7213	REV. NC