

POSITRONIC INDUSTRIES BELIEVES THE DATA ON THIS DRAWING TO BE RELIABLE. SINCE THE TECHNICAL INFORMATION IS GIVEN FREE OF CHARGE, THE USER EMPLOYS SUCH INFORMATION AT HIS OWN DISCRETION AND RISK. POSITRONIC INDUSTRIES ASSUMES NO RESPONSIBILITY FOR RESULTS OBTAINED OR DAMAGES INCURRED FROM USE OF SUCH INFORMATION IN WHOLE OR IN PART.

DATE	REV	REVISION RECORD	APP	DR	CK
7-7-03	NC	ECO 21155		ME	

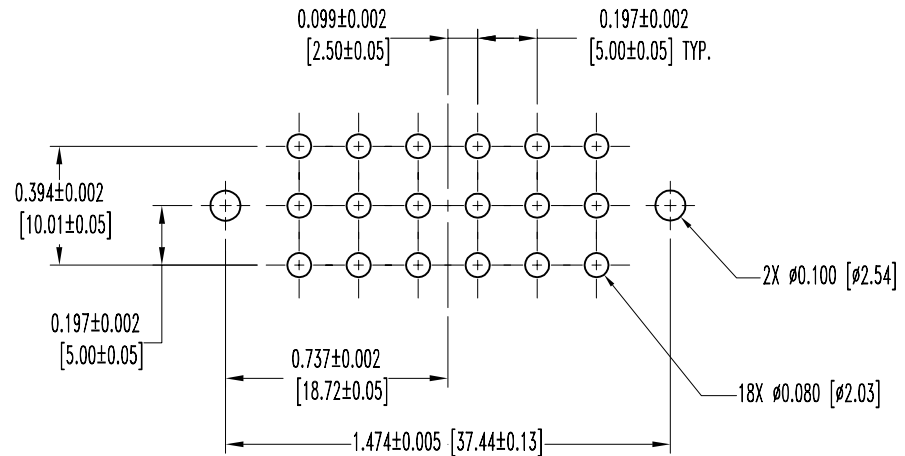
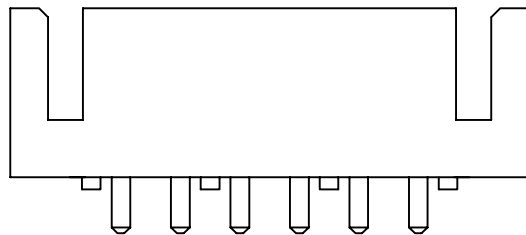
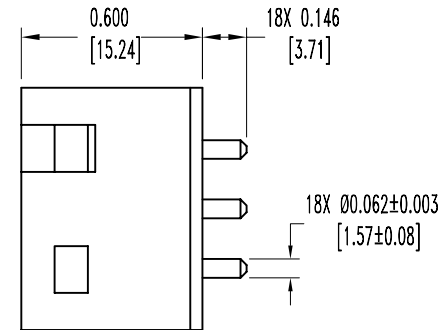
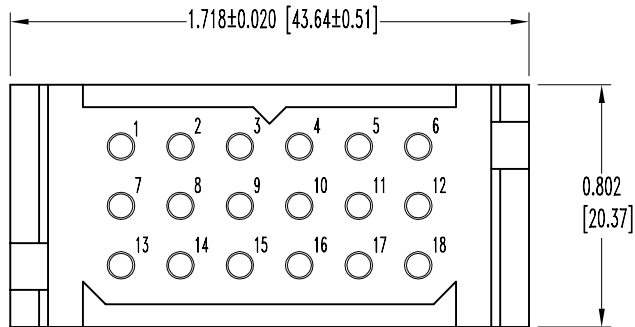

CONTACT HOLE PATTERN

NOTES

- MATERIAL AND FINISHES:
 INSULATOR: GLASS FILLED POLYESTER. UL 94V-0, BLUE.
 CONTACTS: PRECISION MACHINED COPPER ALLOY WITH 0.000030 INCH [0.8µ] GOLD OVER NICKEL.
- ELECTRICAL CHARACTERISTICS:
 CONTACT CURRENT RATING - 25 AMPS. PER IEC 512-3, TEST 5a.
 INITIAL CONTACT RESISTANCE - 0.003 OHMS MAX. PER IEC 512-2, TEST 2b.
 INSULATION RESISTANCE - 5 G OHMS PER IEC 512-2, TEST 3a, METHOD A.
 WORKING TEMPERATURE: -55°C TO +125°C
 WORKING VOLTAGE: 600 V
- DIMENSIONS ARE IN INCHES [MILLIMETERS].

	POSITRONIC INDUSTRIES INC. www.connectpositronic.com		SCALE	DRAWN BY
	PCS SERIES	N.T.S.	M.ENEA	APPROVED BY
DECIMAL TOL. ± 0.015 [0.38]	TITLE PLC18M300C2			
ANGULAR TOL. ± 5°	DATE 7-7-03	DRAWING NUMBER SK5066	REV. NC	