



**POSITRONIC**<sup>®</sup>  
GLOBAL *Connector* SOLUTIONS

Quality Solutions  
Reliable Service

**POSITRONIC INDUSTRIES, INC.**  
Springfield, Missouri USA • 800-641-4054 • [info@connectpositronic.com](mailto:info@connectpositronic.com)

**POSITRONIC INDUSTRIES, S.A.S.**  
Auch, France • 33 5 62 63 44 91 • [contact@connectpositronic.com](mailto:contact@connectpositronic.com)

**POSITRONIC ASIA PTE LTD.**  
Singapore • (65) 6842 1419 • [singapore@connectpositronic.com](mailto:singapore@connectpositronic.com)

---

[www.connectpositronic.com](http://www.connectpositronic.com)

---

## DRAGONFLY BROCHURE CORRECTIONS

Dear Customer:

It is our goal to provide you with up-to-date product literature. In order to achieve this goal, we are supplying the attached pages.

These pages will update your DragonFly Brochure to the new revision of **A-002 Rev B2**. It also will correct errors contained in our printed material and/or provide information about product expansion. These changes are indicated by ***bold italics and are underlined***. Please reference page numbers at bottom of each page for proper locations in the catalog.

If you would like to request additional printed copies, email your request to [info@connectpositronic.com](mailto:info@connectpositronic.com). Please indicate the catalog and revision level requested, along with your name, address, city, state/province, and postal code.

Also, updated PDF catalogs can be obtained by visiting our web site at [www.connectpositronic.com](http://www.connectpositronic.com).

A-002 Rev. B2

**PLEASE UPDATE YOUR CATALOG ACCORDINGLY.**

*We will make these corrections in the upcoming printing of this catalog. Contact us for any additional information at the appropriate location listed above.*

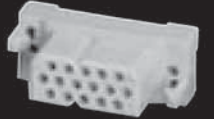

POSITRONIC ASIA PTE. LTD. RESERVES THE DATA ON THE DRAWING TO BE RELIABLE SINCE THE TECHNICAL INFORMATION IS GIVEN FREE OF CHARGE. THE USER EMPLOY'S SUCH INFORMATION AT HIS OWN DISCRETION. POSITRONIC ASIA PTE. LTD. ASSUMES NO LIABILITY FOR DAMAGES INCURRED FROM USE OF SUCH INFORMATION IN WHOLE OR IN PART.

**NOTES:**

- MATERIALS AND FINISHES:**  
INSULATOR: GLASS FILLED NYLON, UL 94V-0 OR EQUIVALENT. COLOR: GREEN.  
CONTACTS: PRECISION MACHINED COPPER ALLOY WITH GOLD FLASH OVER NICKEL.  
REMOVABLE CONTACTS ARE TO BE ORDERED SEPARATELY

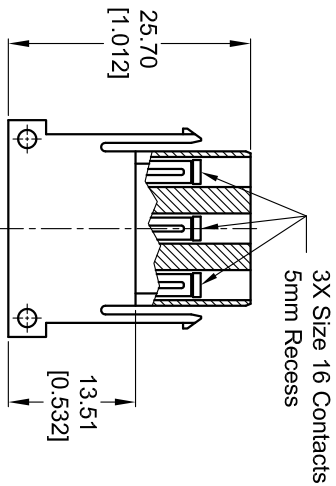
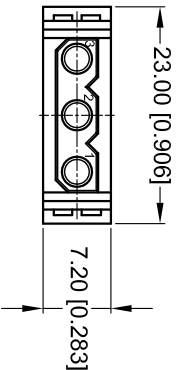

DATE	REV	REVISION RECORD	DRN	CKD	APP
25 MAY 07	NC	PA ECO 07126	NK	KM	KS
30 MAY 07	A	PA ECO 07129	NK	KM	KS
18 AUG 09	B	PA ECO 09159	RG	EH	NK

DRAWING NO.	PART NUMBER	REMARKS
ASK21162-1	DF03F00	-
ASK21162-2	DF03F00/AA	RoHS COMPLIANT PER RoHS DIRECTIVE 2002/95/EC OF 27 JAN 2003.



**POSITRONIC ASIA PTE. LTD.**  
3014A UBI ROAD 1, #07-01, SINGAPORE 408703.  
Tel: (65) 6842-1419 / Fax: (65) 6842-1421 / Email: singapore@connectpositronic.com

GENERAL TOL.		SCALE		DRAWN		CHECKED		APPROVED	
LINEAR	: ±0.38 [0.015]	NTS		NK		KM		KS	
ANGULAR	: ±5°								
UNLESS OTHERWISE SPECIFIED, ALL DIMENSIONS ARE IN MILLIMETERS (INCHES)									
TITLE	DF03F00	DRAWING NUMBER	ASK21162-*	SHEET	1 OF 1	REV.	B		
SERIES	DF	DATE	25 MAY 07						

Unless otherwise stated, Positronic code and part number are marked on each connector. The contents of the code are subjected to the discretion of Positronic Asia Pte Ltd and it is for internal use only. Marking may be done on either side or both sides of the connector.



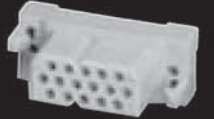

POSITRONIC ASIA PTE LTD. BELIEVES THE DATA ON THE DRAWING TO BE RELIABLE. SINCE THE TECHNICAL DRAWING IS THE PROPERTY OF POSITRONIC ASIA PTE LTD. EMPLOYEES SUCH INFORMATION AT HIS OWN DISCRETION AND RISK. POSITRONIC ASIA PTE LTD. ASSUMES NO RESPONSIBILITY FOR RESULTS OBTAINED OR DAMAGES INCURRED FROM USE OF SUCH INFORMATION IN WHOLE OR IN PART.

**NOTES:**

- MATERIALS AND FINISHES:**  
INSULATOR: GLASS FILLED NYLON, UL 94V-0 OR EQUIVALENT. COLOR: GREEN.  
CONTACTS: PRECISION MACHINED COPPER ALLOY WITH GOLD FLASH OVER NICKEL.  
REMOVABLE CONTACTS ARE TO BE ORDERED SEPARATELY

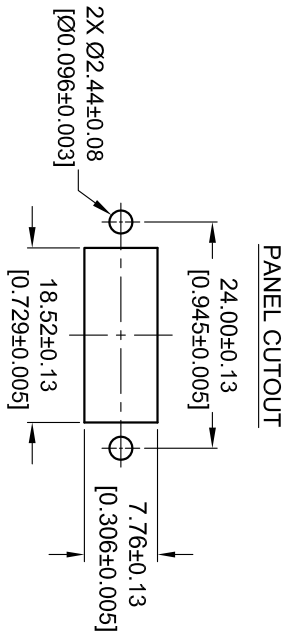
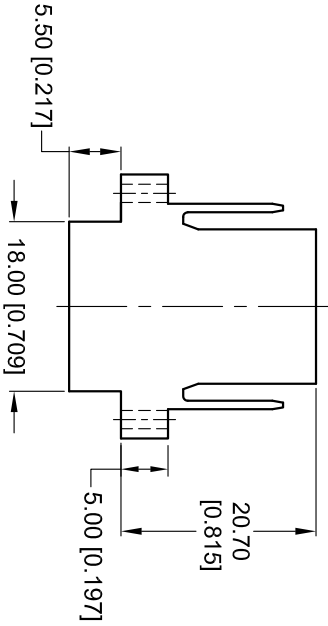
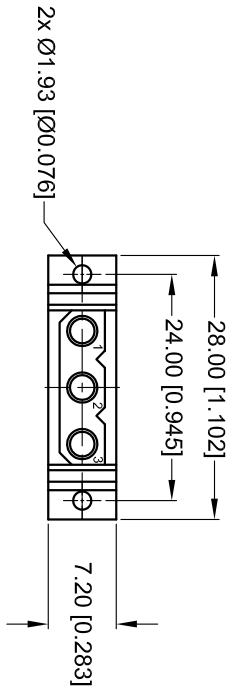

DATE	REV	REVISION RECORD	DRN	CKD	APF
25 MAY 07	NC	PA ECO 07126	NK	KM	KS
30 MAY 07	A	PA ECO 07129	NK	KM	KC
02 NOV 07	B	PA ECO 07231	EH	RG	KS
18 AUG 09	C	PA ECO 09159	RG	EH	NK

DRAWING NO.	PART NUMBER	REMARKS
ASK21161-1	DF03M0P	-
ASK21161-2	DF03M0P/AA	RoHS COMPLIANT PER RoHS DIRECTIVE 2002/95/EC OF 27 JAN 2003.

		<b>POSITRONIC ASIA PTE. LTD.</b> 3014A UBI ROAD 1, #07-01, SINGAPORE 408703. Tel: (65) 6842-1419 / Fax: (65) 6842-1421 / Email: singapore@connectpositronic.com	
GENERAL TOL.	LINEAR : ±0.30 [0.012]	SCALE	DRAWN
	ANGULAR : ±5°	NTS	NK
SERIES	DF	CHECKED	KM
TITLE	DF03M0P	APPROVED	KS
	DF03M0P/AA	DATE	25 MAY 07
UNLESS OTHERWISE SPECIFIED ALL DIMENSIONS ARE IN MILLIMETERS (INCHES)	DRAWING NUMBER	SHEET	1 OF 1
	ASK21161-1*	REV.	C

Unless otherwise stated, Positronic code and part number are marked on each connector. The contents of the code are subjected to the discretion of Positronic Asia Pte Ltd and it is for internal use only. Marking may be done on either side or both sides of the connector.





# COMPLIANT PRESS-FIT CONNECTORS FOR CONNECTOR VERSIONS 04, 07, 10 AND 16

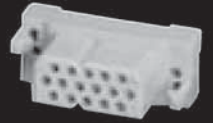

## SUGGESTED PRINTED BOARD HOLE SIZES COMPLIANT PRESS-FIT CONNECTORS

Traditionally, tin-lead has been a popular plating for PCB holes. However, many PCB hole platings must now be RoHS Compliant. Positronic is pleased to offer **PCB HOLE SIZE FOR RoHS** PCB plating as shown below.

<b>BI-SPRING COMPLIANT PRESS-FIT CONTACT HOLE</b>				
BOARD TYPE	CONTACT SIZE	RECOMMENDED DRILL HOLE SIZE	RECOMMENDED PLATING	FINISHED HOLE SIZES
TIN-LEAD SOLDER PCB	16	$\phi 1.750 \pm 0.025$ [ $\phi 0.0689 \pm 0.001$ ]	15 $\mu$ [0.0006] minimum solder over 25 $\mu$ [0.0010] min. copper	$\phi 1.600 \pm 0.090 - 0.060$ [ $\phi 0.0630 \pm 0.0035 - 0.0024$ ]
<b>RoHS PCB PLATING OPTIONS</b>				
COPPER PCB	16	$\phi 1.750 \pm 0.025$ [ $\phi 0.0689 \pm 0.001$ ]	25 $\mu$ [0.0010] min. copper	$\phi 1.600 \pm 0.090 - 0.060$ [ $\phi 0.0630 \pm 0.0035 - 0.0024$ ]
IMMERSION TIN PCB	16	$\phi 1.750 \pm 0.025$ [ $\phi 0.0689 \pm 0.001$ ]	0.85 $\pm 0.15\mu$ [0.000033 $\pm 0.000006$ ] immersion tin over 25 $\mu$ [0.0010] min. copper	$\phi 1.600 \pm 0.090 - 0.060$ [ $\phi 0.0630 \pm 0.0035 - 0.0024$ ]
IMMERSION SILVER PCB	16	$\phi 1.750 \pm 0.025$ [ $\phi 0.0689 \pm 0.001$ ]	0.34 $\pm 0.17\mu$ [0.000013 $\pm 0.000007$ ] immersion silver over 25 $\mu$ [0.0010] min. copper	$\phi 1.600 \pm 0.090 - 0.060$ [ $\phi 0.0630 \pm 0.0035 - 0.0024$ ]
ELECTROLESS NICKEL/IMMERSION GOLD PCB	16	$\phi 1.750 \pm 0.025$ [ $\phi 0.0689 \pm 0.001$ ]	0.05 $\mu$ [0.000002] min. immersion gold over [4.5 $\pm 1.5\mu$ [0.000177 $\pm 0.000059$ ] electroless nickel per IPC-4552 over 25 $\mu$ [0.0010] min. copper	$\phi 1.600 \pm 0.090 - 0.060$ [ $\phi 0.0630 \pm 0.0035 - 0.0024$ ]

“Bi-Spring” Termination

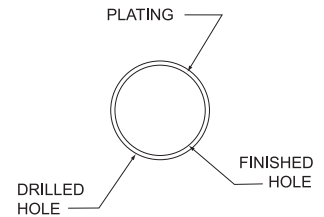
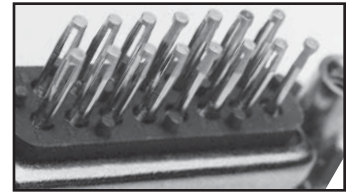

**PRESS-FIT CONTACT HOLE**

Note: For PCB plating compositions not shown, consult Technical Sales.

<b>OMEGA COMPLIANT PRESS-FIT CONTACT HOLE</b>				
BOARD TYPE	CONTACT SIZE	RECOMMENDED DRILL HOLE SIZE	RECOMMENDED PLATING	FINISHED HOLE SIZES
TIN-LEAD SOLDER PCB	20 22	$\phi 1.150 \pm 0.025$ [ $\phi 0.0453 \pm 0.001$ ]	15 $\mu$ [0.0006] minimum solder over 25 $\mu$ [0.0010] min. copper	$\phi 1.000 \pm 0.090 - 0.060$ [ $\phi 0.0394 \pm 0.0035 - 0.0024$ ]
<b>RoHS PCB PLATING OPTIONS</b>				
COPPER PCB	20 22	$\phi 1.19 \pm 0.025$ [ $\phi 0.047 \pm 0.001$ ]	25 $\mu$ [0.0010] min. copper	$\phi 1.09 \pm 0.05$ [ $\phi 0.043 \pm 0.002$ ]
IMMERSION TIN PCB	20 22	$\phi 1.19 \pm 0.025$ [ $\phi 0.047 \pm 0.001$ ]	0.85 $\pm 0.15\mu$ [0.000033 $\pm 0.000006$ ] immersion tin over 25 $\mu$ [0.0010] min. copper	$\phi 1.09 \pm 0.05$ [ $\phi 0.043 \pm 0.002$ ]
IMMERSION SILVER PCB	20 22	$\phi 1.19 \pm 0.025$ [ $\phi 0.047 \pm 0.001$ ]	0.34 $\pm 0.17\mu$ [0.000013 $\pm 0.000007$ ] immersion silver over 25 $\mu$ [0.0010] min. copper	$\phi 1.09 \pm 0.05$ [ $\phi 0.043 \pm 0.002$ ]
ELECTROLESS NICKEL/IMMERSION GOLD PCB	20 22	$\phi 1.19 \pm 0.025$ [ $\phi 0.047 \pm 0.001$ ]	0.05 $\mu$ [0.000002] min. immersion gold over 4.5 $\pm 1.5\mu$ [0.000177 $\pm 0.000059$ ] electroless nickel per IPC-4552 over 25 $\mu$ [0.0010] min. copper	$\phi 1.09 \pm 0.05$ [ $\phi 0.043 \pm 0.002$ ]

“Omega” Termination

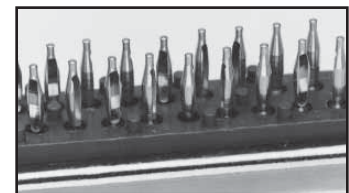

**Note:**

DF04 - uses size 16 bi-spring press-fit and size 22 omega press-fit contacts.

DF07 - uses size 16 bi-spring press-fit contacts.

DF10 - uses size 20 omega press-fit contacts.

DF16 - uses size 22 omega press-fit contacts.

